



# SHINGLE & SHAKE

SHINGLE ROOFING INSTALLERS

Shingle & Shake

16A Parkhead Place, Albany, Auckland, New Zealand,

T : 0800-SHINGLE | [www.shingleandshake.co.nz](http://www.shingleandshake.co.nz)

Copyright © of this drawing shall remain the property of SPS Roofing and Building Ltd.  
No part of this document may be edited by any means without the prior permission in  
writing of SPS Roofing and Building Ltd.

Details for use by Shingle & Shake

By express licence of SPS Roofing and Building Ltd.

{v1.0}



Original In Colour

### Drawing Register

Sheet Number	Sheet Title	Detail Type	Revision Version	Scale Shown
0.1	Title Page	Information	v1.0	NTS
0.2	Detail Register	Information	v1.0	NTS
0.3	Fastening Selection and Methodology	Information	v1.0	NTS
0.4	Construction Notes	Information	v1.0	NTS
0.5	Fixing Specification	Information	v1.0	NTS
1.1	Specific Framing Requirements	3D Cutaway Details	v1.0	NTS
1.2	Inlet & Outlet Airflow	Sectional Details	v1.0	NTS
1.3	Apron Flashings	Sectional Details	v1.0	NTS
1.4	Roof to Wall	Sectional Details	v1.0	NTS
1.5	Pitch Changes	Sectional Details	v1.0	NTS
1.6	Step Flashings & Wall Termination	3D Cutaway Details	v1.0	NTS
1.7	Barge End & Valley	3D Cutaway Details	v1.0	NTS
1.7.1	Staggered Valley Alternative	3D Cutaway Details	v1.0	NTS
1.8	Apron Termination	3D Cutaway Details	v1.0	NTS
1.9	Kickout Flashing	3D Cutaway Details	v1.0	NTS
2.1	Gable to Ridge	3D Step-by-Step Details	v1.0	NTS
2.2	Dormer to Valley	3D Step-by-Step Details	v1.0	NTS
2.3	Dutch Gable	3D Step-by-Step Detail	v1.0	NTS
2.4	Large Penetrations	3D Cutaway Details	v1.0	NTS
2.5	Small Penetrations	3D Cutaway Details	v1.0	NTS
2.6	Drainage Spreader	3D Cutaway Details	v1.0	NTS
2.7	Wall to Roof BOC	3D Cutaway Details	v1.0	NTS
2.8	Internal Junctions to Wall BOC	3D Cutaway Details	v1.0	NTS
2.9	Ridge & Hip Caps	3D Cutaway Details	v1.0	NTS
3.1	Penetration Openings	3D Cutaway Details	v1.0	NTS
3.2	Roof Vents	Sectional Details	v1.0	NTS
3.3	Box Vent Installation	3D Cutaway Details	v1.0	NTS
3.4	Typical Flashing Dimensions	Sectional Details	v1.0	NTS

**SHINGLE & SHAKE**

SHINGLE ROOFING INSTALLERS

Shingle & Shake  
16A Parkhead Place, Albany, Auckland, New Zealand,  
T : 0800-SHINGLE | www.shingleandshake.co.nz

Sheet Title:

Detail Register  
Information

Sheet Status:

For Design & Information  
S&S Technical Drawings 2020  
Technical Specification Subject to Change

Sheet Number:

0.2

Revision:

{v1.0}

Revision Date

Jan. 2020

Scale @ A4:

NTS



# FASTENERS

While nailing is the preferred method for fixing raised roof profile shingles, SPS Building accept fastening methods according to and in accordance with Owens Corning specifications.

**ALWAYS NAIL THROUGH THE FASTENER LINE.**

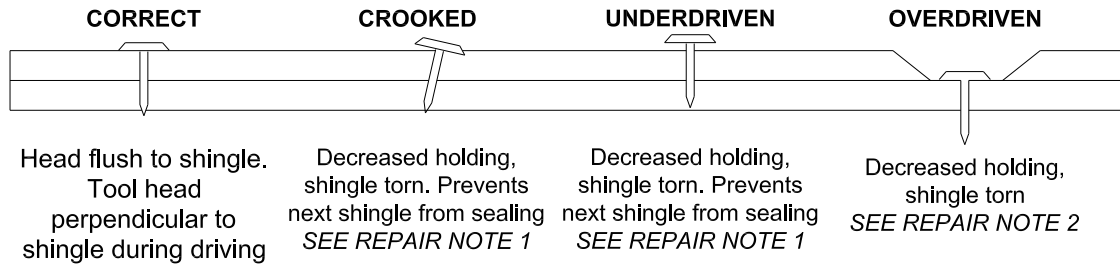

**REPAIR NOTE 1:**

FLATTEN NAIL HEAD TO PREVENT INTERFERENCE WITH NEXT SHINGLE

**REPAIR NOTE 2:**

DRIVE ANOTHER NAIL NEARBY. SEAL OVERDRIVEN NAIL WITH SPS BUILDING BITUMINOUS ROOFING SEALANT

**MATERIAL:** Refer to NZS 3604:2011 section 4.4 for corrosion protection requirements

**NAILS:** 10mm Head 12 gauge roofing nails.

SPS Building recommends 32mm nails for new roofs and roof overs.

In cases where applying shingles to a roof that has an exposed overhang 20mm ring shank nails are allowed to be used from the eaves edge to a point up the roof that is past the outside wall line.

**NOTE:** an improperly adjusted nail gun can result in under driven nails that can cause a lipped appearance, this can prevent correct sealing.

**SHINGLE & SHAKE**

SHINGLE ROOFING INSTALLERS

Shingle & Shake  
16A Parkhead Place, Albany, Auckland, New Zealand,  
T : 0800-SHINGLE | www.shingleandshake.co.nz

Sheet Title:

Fastening Selection and Methodology  
Information



Sheet Status:

For Design & Information  
S&S Technical Drawings 2020  
Technical Specification Subject to Change

Sheet Number:

0.3

Revision:

{v1.0}

Revision Date

Jan. 2020

Scale @ A4:

NTS

# CONSTRUCTION NOTES

READ THOROUGHLY BEFORE COMMENCING WORKS:

- All materials to be dry at the time of application.  
.: Under no circumstances should any materials be torch dried.
- All sarking and substrate materials to be dry prior to laying of waterproof membrane.
- Ensure all condensation and rainwater has thoroughly evaporated prior to commencement of works.
- All flashing and fixing materials to be corrosion resistant and approved for the corrosion zone as specified by the New Zealand building code and NZS 3604:2011.
  - Sea spray zones - type 304 stainless steel
  - All other zones type 304 stainless steel or hot dip galvanised with additional protection as per NZS 3604:2011 4.4.4 and 4.4.5 requirements.
- For high, very high and extra wind zones, the number of fixings per shingle shall be 6 nails per tile and all shingle rakes and eaves to be glued with approved roofing cement.
- Plywood substrate to be laid with staggered joints to sheet edges.
- All sheet edges shall be supported with nogs or roof framing for fixing unless a structurally tested and approved tongue in groove edge shall provide equivalent or better support.
- Galvanised 'H' clips may be used for square edge plywood.
- All sheets must be laid with a 3mm inter sheet expansion joint plywood substrate shall be laid with the face grain at right angles to the supports.
- Under no circumstances shall the sarking / substrate be laid diagonally.
- All sarking / substrates shall have a max of 18% moisture content at the time of application.
- All underlays must be laid with MINIMUM 100mm end/edge laps.

## SHINGLE & SHAKE

SHINGLE ROOFING INSTALLERS

Shingle & Shake

16A Parkhead Place, Albany, Auckland, New Zealand,  
T: 0800-SHINGLE | www.shingleandshake.co.nz

Sheet Title:

Construction Notes  
Information

Sheet Status:

For Design & Information  
S&S Technical Drawings 2020  
Technical Specification Subject to Change

Sheet Number:

0.4

Revision:

{v1.0}

Revision Date

Jan. 2020

Scale @ A4:

NTS



# FIXING SPECIFICATION

READ THOROUGHLY BEFORE COMMENCING WORKS:

## - Roof Penetrations

Roof decks / substrates should be dry, well-seasoned 150x25 boards or exterior grade plywood.

## - Underlay

Apply Titanium 30 roofing underlay over plywood substrate in accordance with NZBC E2 requirements 8.1.5. All roof underlays shall have laps of no less than 100mm, roof underlays shall be laid horizontally with the upper sheets lapped over lower sheets to ensure water is shed to the outer face of the underlay.

## - Roof Pitch

- Minimum acceptable roof pitch = 9.5°.

- For roof pitches 9.5° - 12° completely cover roof with 2 layers of underlay or 1 layer of 'peel and stick' in accordance with manufacturers specifications.

- For roof pitches 12° and greater completely cover roof area with 1 layer of roofing underlay.

## - Shingle Starter Course

Use Owens Corning starter strip or a strip shingle inverted with the head-lap applied at the eave edge with at least 10mm trimmed from the end of the first shingle, starting at the rake edge and overhanging the eave 12mm to 20mm. Fasten 50mm from the lower edge and 25mm from each side. Shingles may be applied with a course alignment of 45° on the roof.

### - First Course

Start at rake and continue course with full shingles laid flush with the starter course.

### - Second Course

Start at the rake with the shingle having 145mm trimmed off and continue across roof with full length shingles.

### - Third Course

Start at the rake with the shingle having 285mm trimmed off and continue across with full length shingles.

### - Fourth Course

Start at the rake and continue across with full length shingles across roof.

### - Fifth and Proceeding Courses

Repeat the application as shown for second, third and fourth courses. do not tack shingles straight up the roof.

## - Fasteners

Always nail through the fastener line.

Shingling nails: Stainless Steel Gun Nails with 9mm head, semi ring shanked, 32mm or 25mm in length with a 3mm diameter shank. In cases where applying shingles to a roof that has an exposed overhang, (for new roofs only), 20mm ring shank nails may be used from the eave edge to a point up the roof that is past the outside wall line 25mm ring shank nails allowed for re-roof.

## - NOTE:

- An improperly adjusted nail gun can result in underdriven nails that can cause a lipped appearance and prevent correct sealing.

- Fasteners should be long enough to obtain a 19mm embedment or penetrate through substrate whichever is less.

# SHINGLE & SHAKE

SHINGLE ROOFING INSTALLERS

Shingle & Shake

16A Parkhead Place, Albany, Auckland, New Zealand,  
T : 0800-SHINGLE | www.shingleandshake.co.nz

Sheet Title:

Fixing Specification  
Information

Sheet Status:

For Design & Information  
S&S Technical Drawings 2020  
Technical Specification Subject to Change

Sheet Number:

0.5

Revision:

{v1.0}

Revision Date

Jan. 2020

Scale @ A4:

NTS



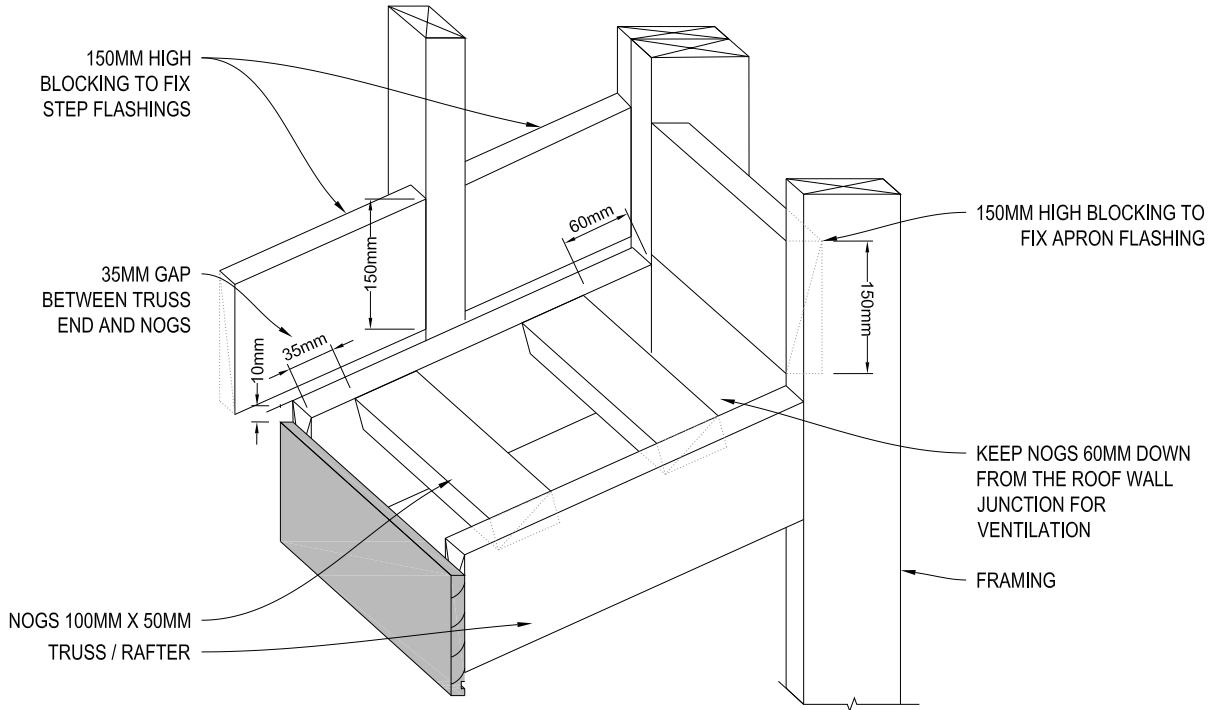

1. WALL - ROOF INTERSECTION FRAMING

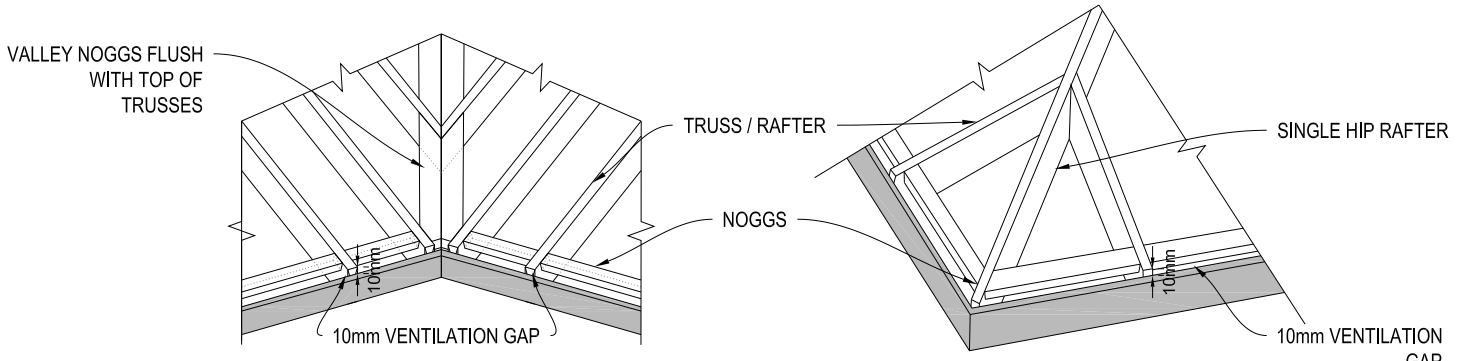

2. VALLEY FRAMING

3. HIP FRAMING

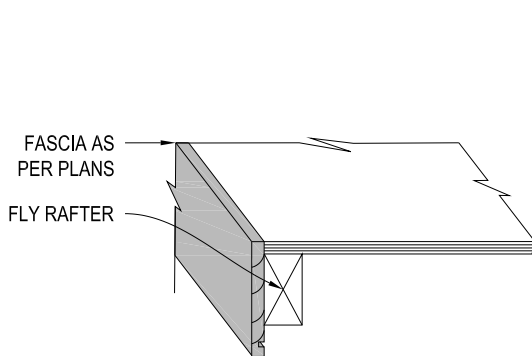

4. BARGE FRAMING

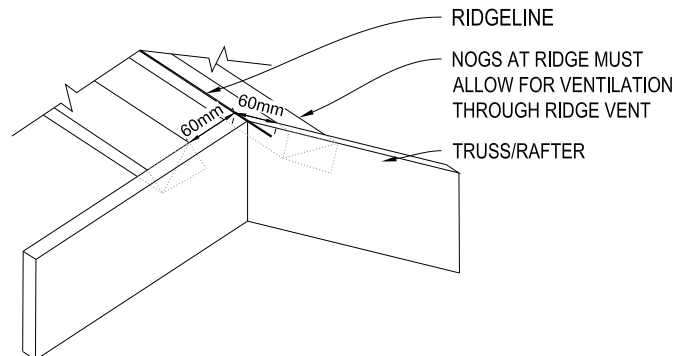

5. RIDGE FRAMING

**SHINGLE & SHAKE**

SHINGLE ROOFING INSTALLERS

Shingle & Shake  
16A Parkhead Place, Albany, Auckland, New Zealand,  
T: 0800-SHINGLE | www.shingleandshake.co.nz

Sheet Title:

Specific Framing Requirements  
3D Cutaway Details

Sheet Status:

For Design & Information  
S&S Technical Drawings 2020  
Technical Specification Subject to Change

Sheet Number:

1.1

Revision:

{v1.0}

Revision Date

Jan. 2020

Scale @ A4:

NTS



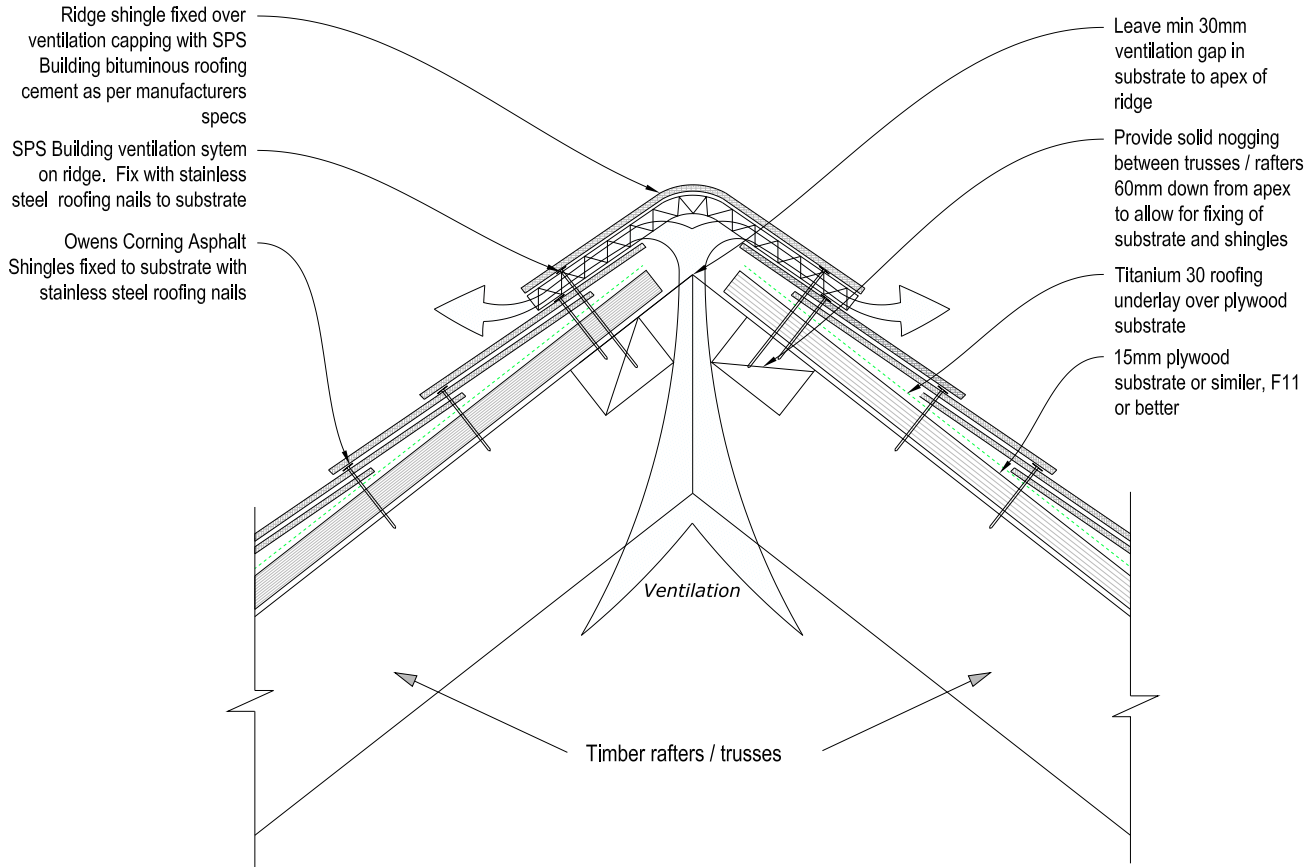

1. VENTED RIDGE

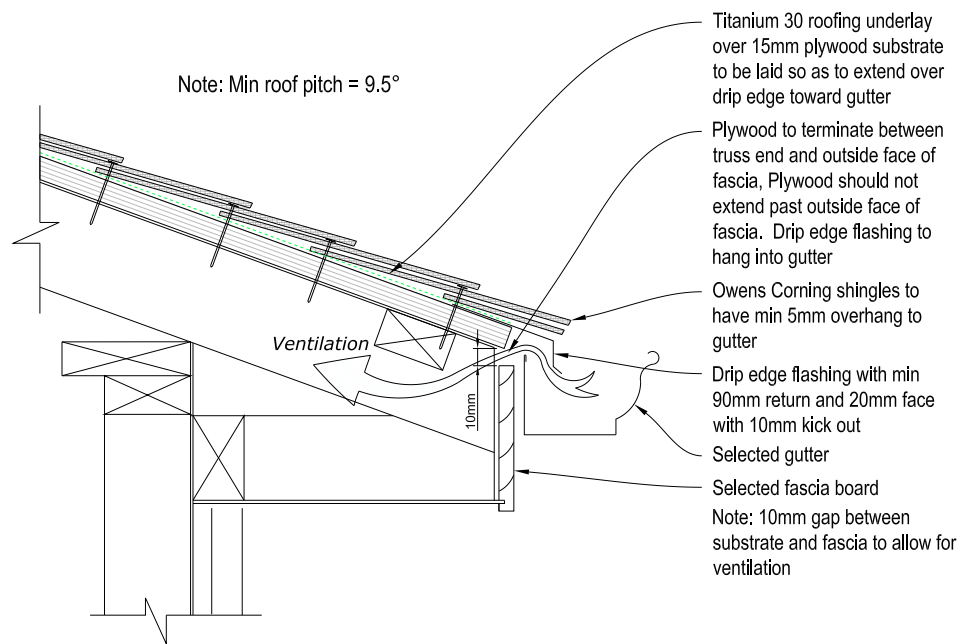

2. EAVE

**SHINGLE & SHAKE**

SHINGLE ROOFING INSTALLERS

Shingle & Shake  
16A Parkhead Place, Albany, Auckland, New Zealand,  
T: 0800-SHINGLE | www.shingleandshake.co.nz

Sheet Title:	Sheet Status:	Sheet Number:	Revision:
Inlet & Outlet Airflow Sectional Details	For Design & Information S&S Technical Drawings 2020 Technical Specification Subject to Change	1.2	{v1.0}
		Revision Date	Jan. 2020
		Scale @ A4:	NTS

Framing as per plans  
 Provide continuous support to flashing upstand  
 Provide solid noggings between trusses / rafters to allow for fixing of substrate and shingles  
 Rafters / Trusses as per plans

Building wrap to be laid over flashing  
 Butynol or EPDM apron flashing to provide approx 150mm cover to the shingle weathering strip (May vary depending on shingle profile)  
 For aesthetic purposes, shingle to be fixed over apron flashing with SPS Building bituminous roofing cement as per manufacturers specs  
 SPS Building Owens Corning Asphalt Shingles fixed to substrate with stainless steel roofing nails and SPS Building bituminous roofing cement  
 Titanium 30 roofing underlay over 15mm plywood substrate

**: NOTE :**  
 When venting is not possible/allowed for at the top of a roof line: (e.g. at and Apron Flashing or Ridge)  
 Box vents other approved cavity vent must be used.  
 Refer to Sheet 3.2 for selection criteria

**1. APRON FLASHING**

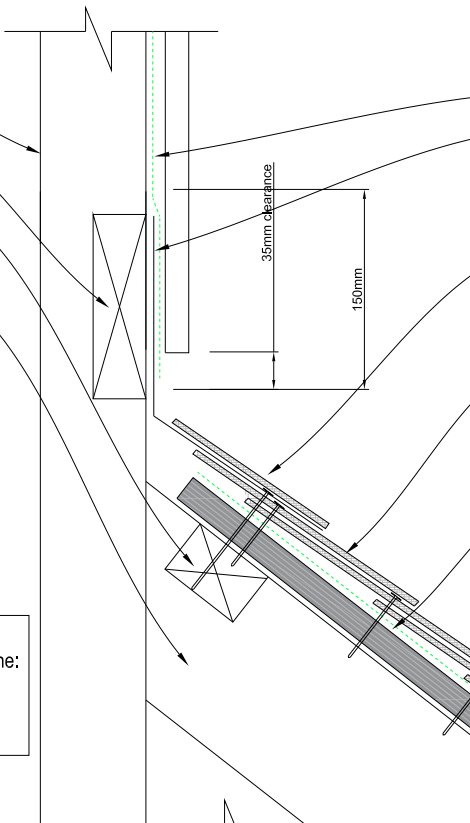

Framing as per plans  
 Provide continuous support to flashing upstand  
 Leave min 30mm ventilation gap between nogs and Plywood to framing  
 Provide solid noggings between trusses / rafters to allow for fixing of substrate and shingles  
 Rafters / Trusses as per plans

Building wrap to be laid over flashing  
 Butynol or EPDM apron flashing to provide approx 150mm cover to the shingle weathering strip (May vary depending on shingle profile)  
 For aesthetic purposes, shingle to be fixed over apron flashing with SPS Building bituminous roofing cement as per manufacturers specs  
 SPS Building ventilation sytem to apron flashing. Fix with stainless steel roofing nails to substrate  
 SPS Building Owens Corning Asphalt Shingles fixed to substrate with stainless steel roofing nails and SPS Building bituminous roofing cement  
 Titanium 30 roofing underlay over 15mm plywood substrate

**2. VENTED APRON FLASHING**

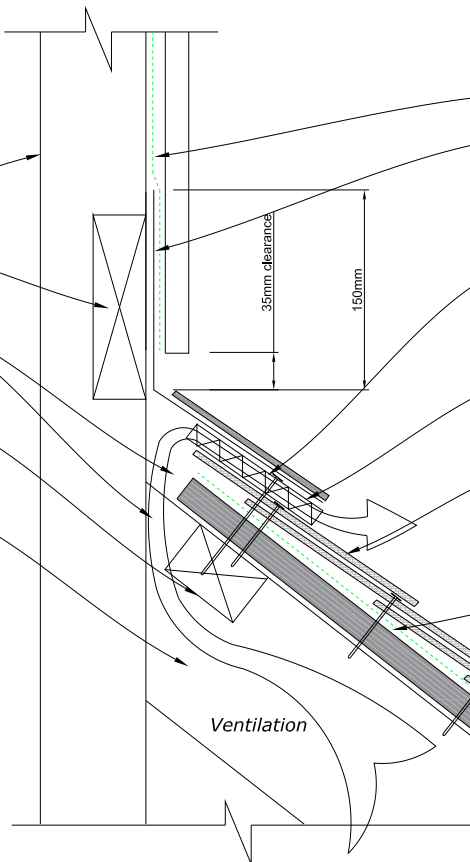

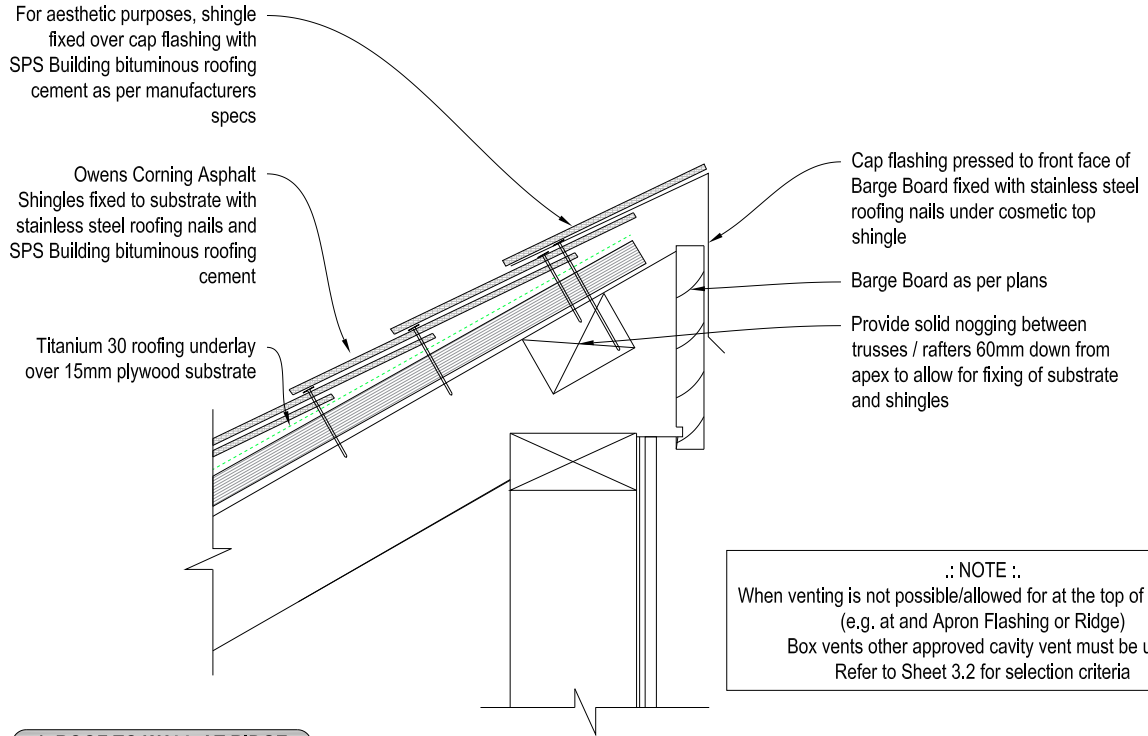

**1. ROOF TO WALL AT RIDGE**

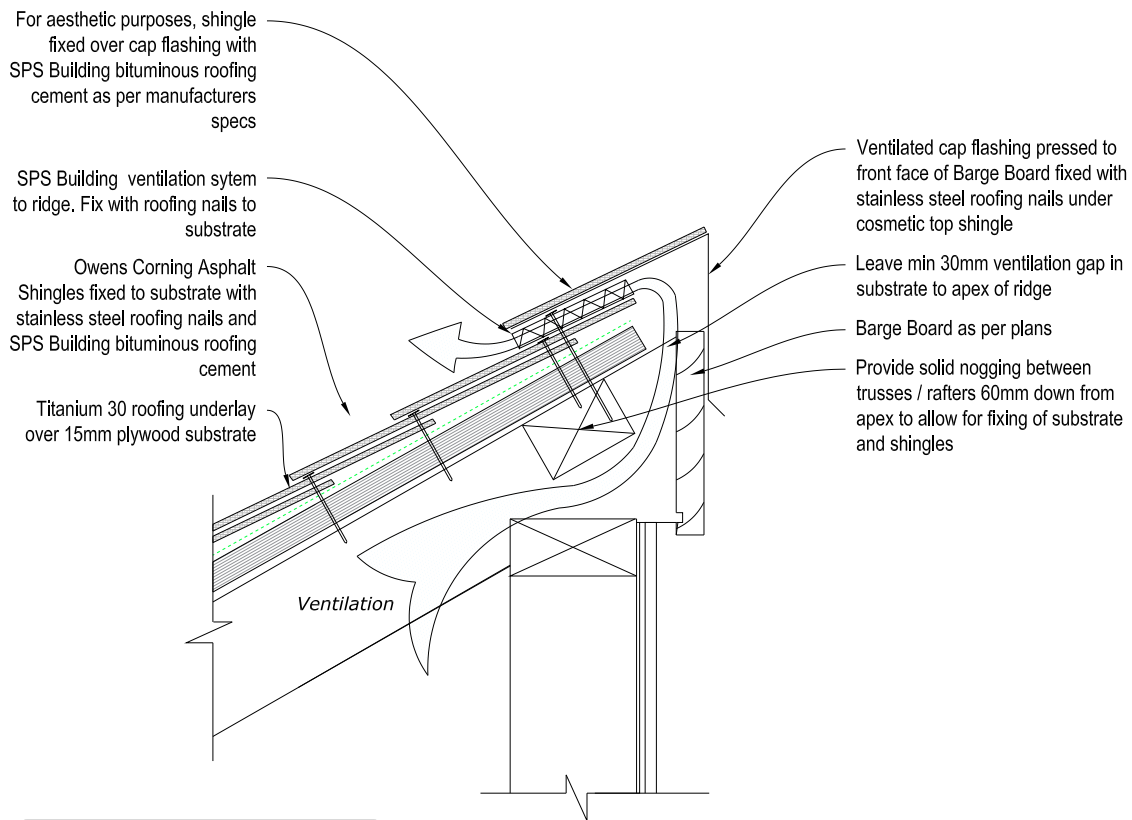

**2. VENTED ROOF TO WALL AT RIDGE**

Sheet Title:	Sheet Status:	Sheet Number:	Revision:
Roof to Wall Sectional Details	For Design & Information S&S Technical Drawings 2020 Technical Specification Subject to Change	1.4	{v1.0}
		Revision Date	Jan. 2020
		Scale @ A4:	NTS

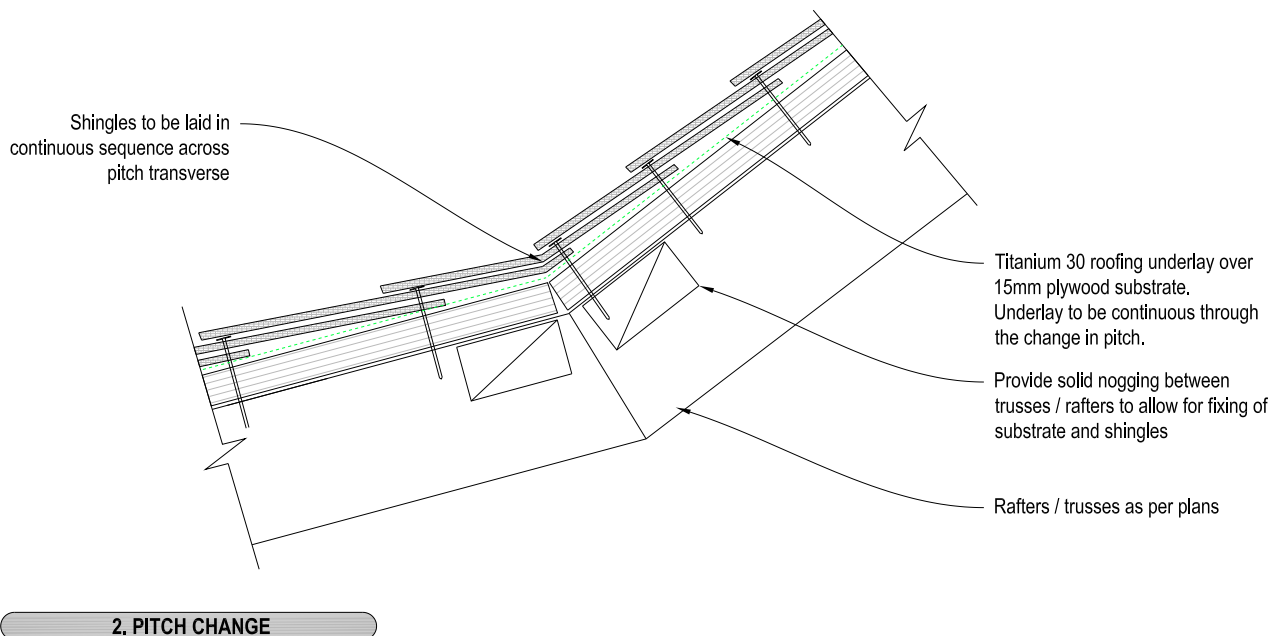
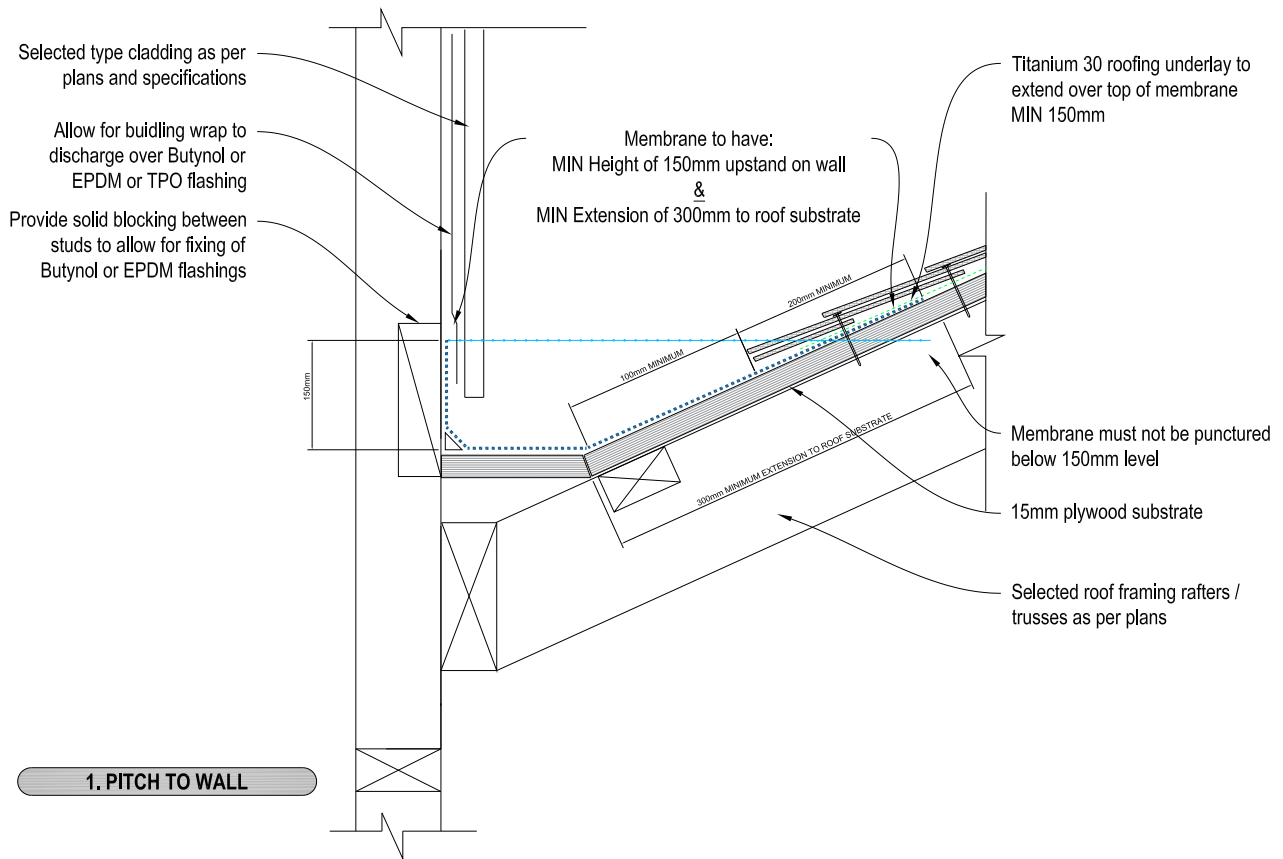

# SHINGLE & SHAKE

SHINGLE ROOFING INSTALLERS

Shingle & Shake  
16A Parkhead Place, Albany, Auckland, New Zealand,  
T: 0800-SHINGLE | www.shingleandshake.co.nz

Sheet Title:

Pitch Changes  
Sectional Details

Sheet Status:

For Design & Information  
S&S Technical Drawings 2020  
Technical Specification Subject to Change

Sheet Number:

1.5

Revision:

{v1.0}

Revision Date

Jan. 2020

Scale @ A4:

NTS



**NOTE:** Step flashings are required to be a minimum 250x300mm in size with 80 -100mm minimum overlap between step flashings. Cladding must overlap step flashings a minimum of 70mm.

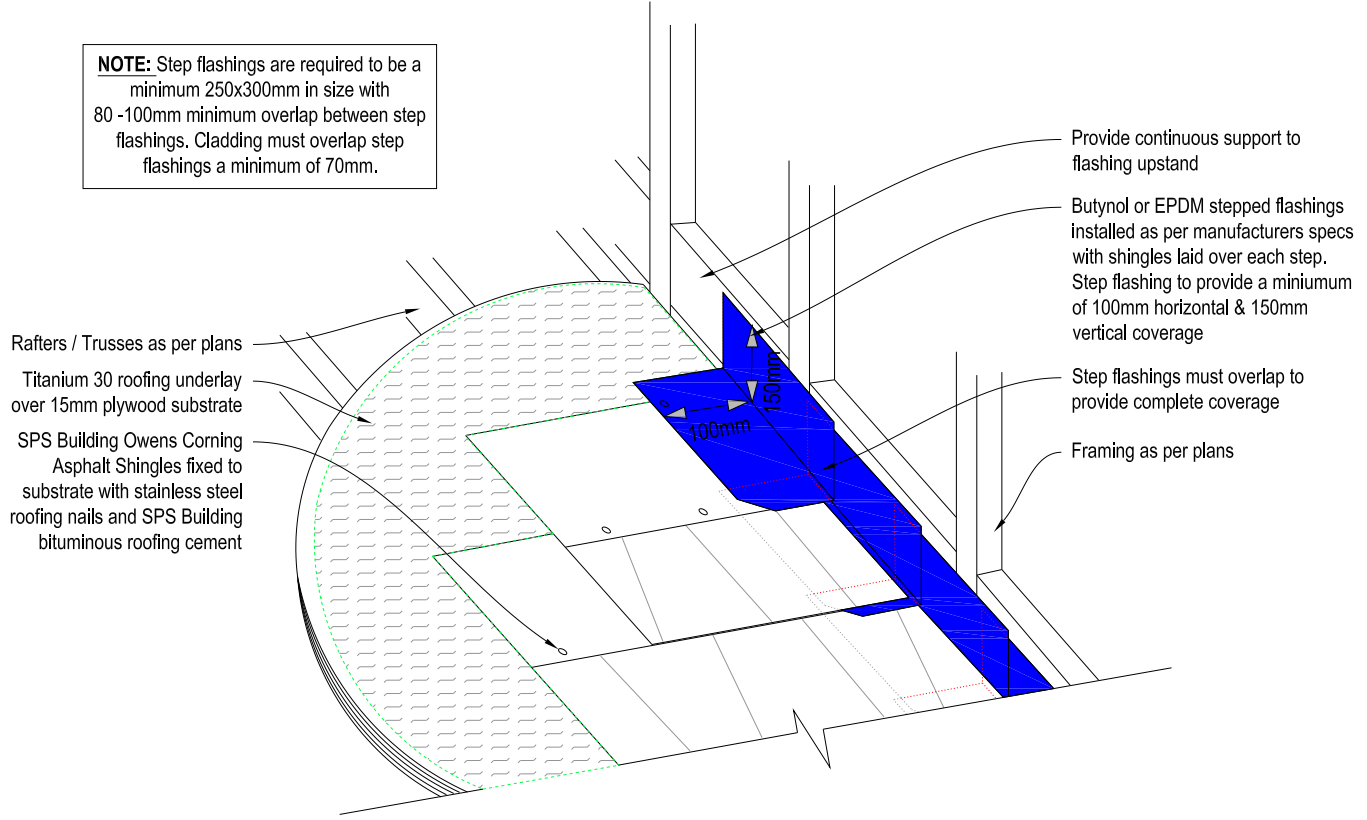

**1. STEP FLASHING**

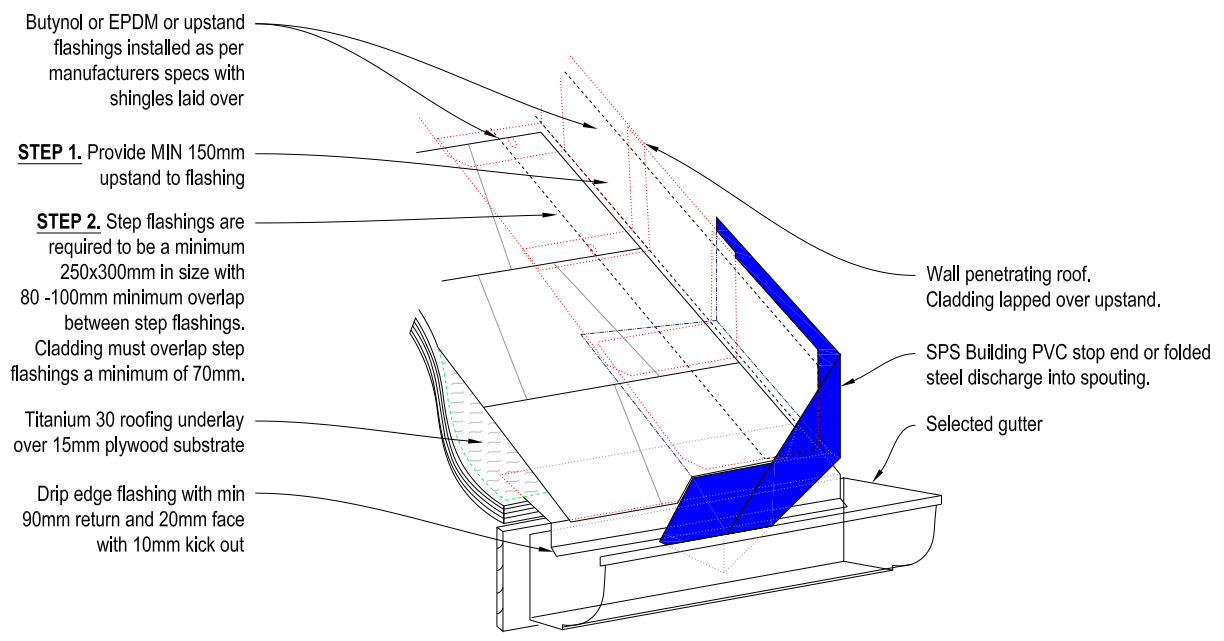

**2. GUTTER TO WALL JUNCTION**

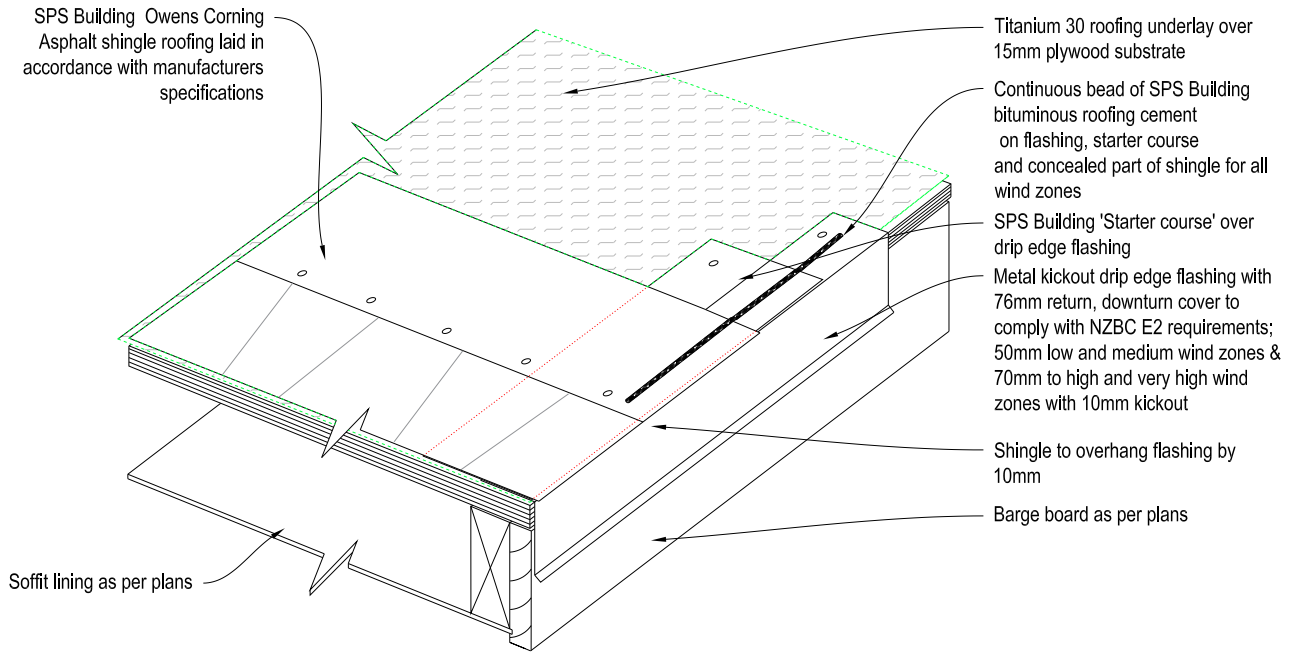

**1. BARGE END**

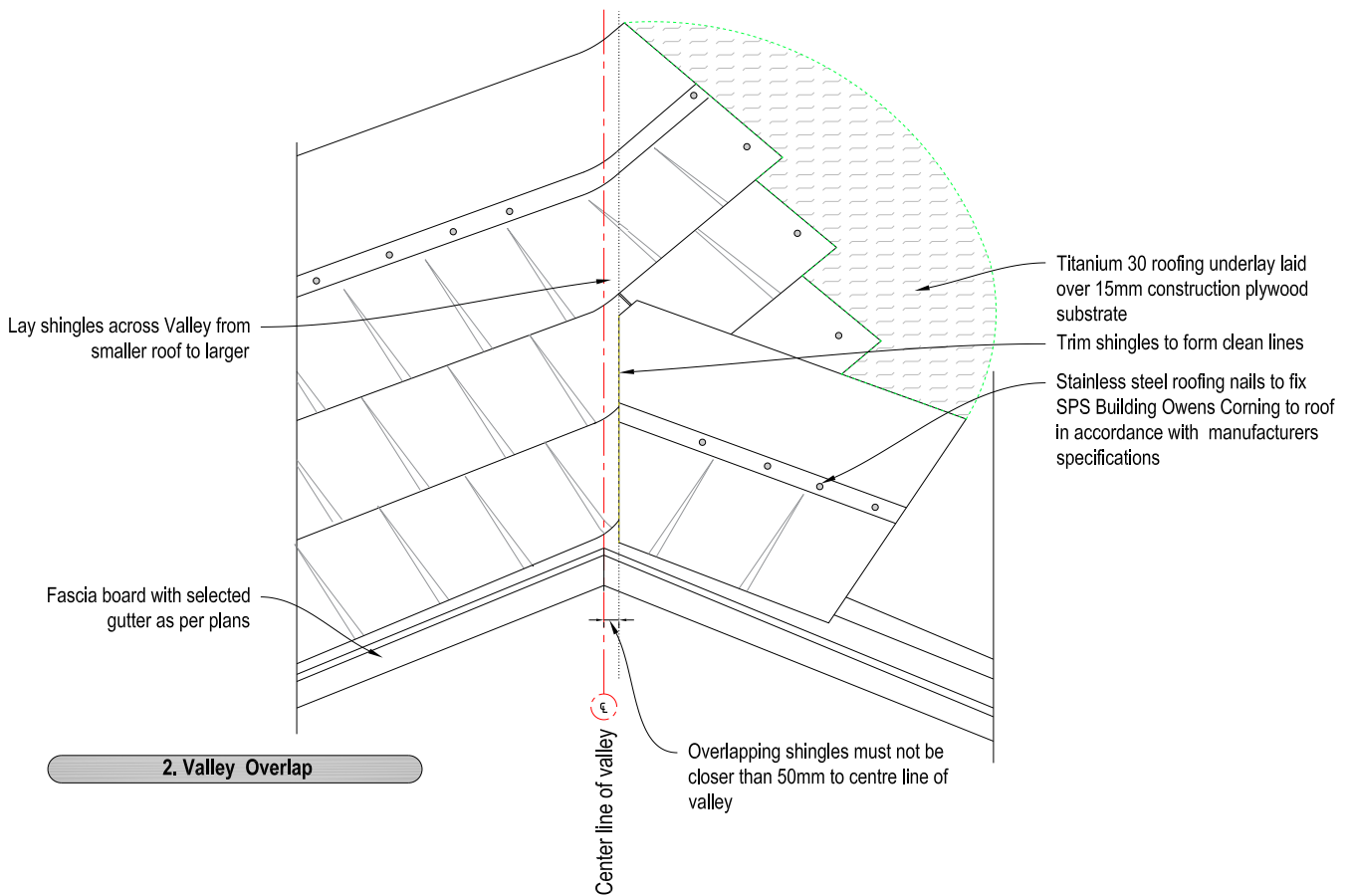

**2. Valley Overlap**

**SHINGLE & SHAKE**

SHINGLE ROOFING INSTALLERS

Shingle & Shake  
16A Parkhead Place, Albany, Auckland, New Zealand,  
T : 0800-SHINGLE | www.shingleandshake.co.nz

Sheet Title:

Barge End & Valley  
3D Cutaway Details

Sheet Status:

For Design & Information  
S&S Technical Drawings 2020  
Technical Specification Subject to Change

Sheet Number:

1.7

Revision:

{v1.0}

Revision Date

Jan. 2020

Scale @ A4:

NTS

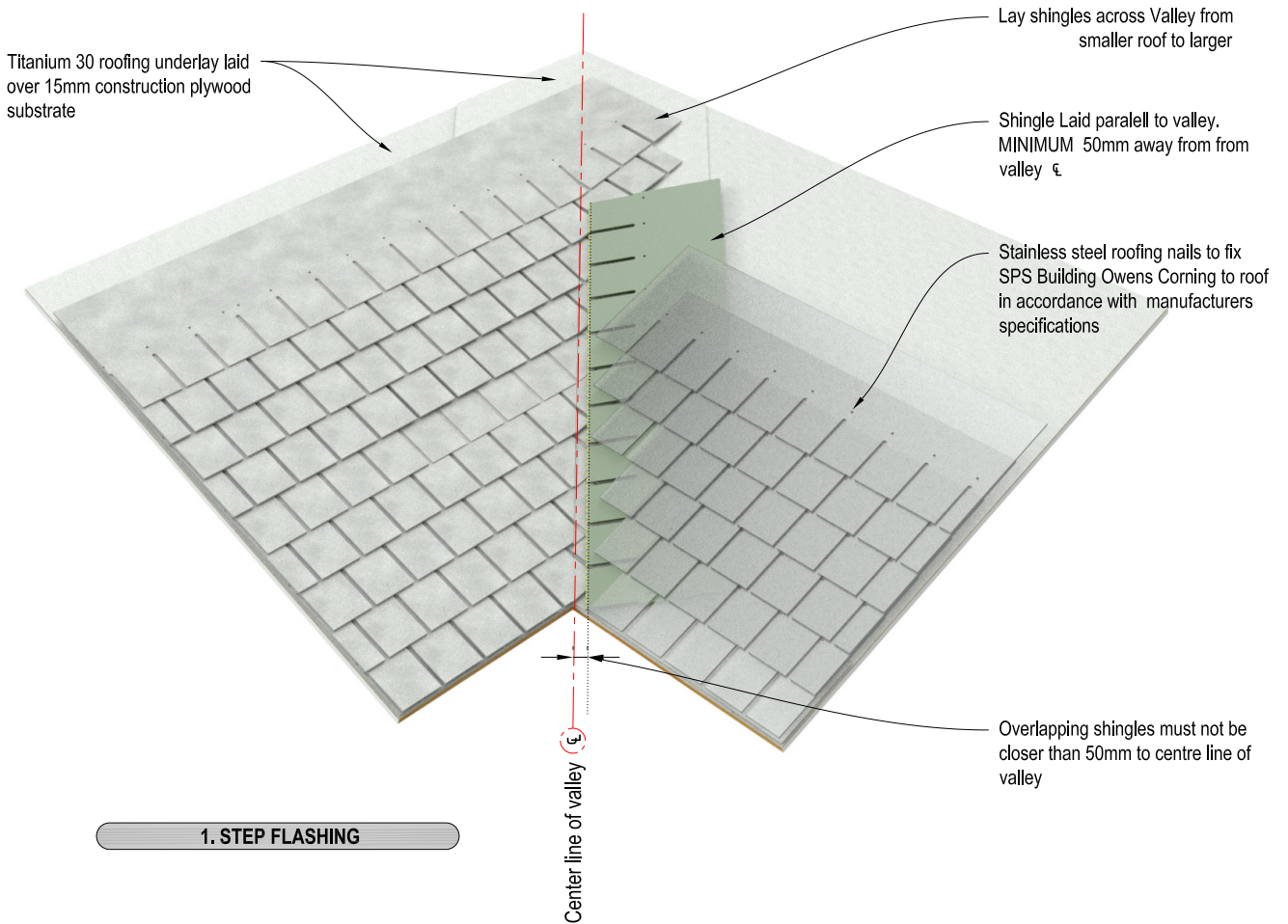

# SHINGLE & SHAKE

SHINGLE ROOFING INSTALLERS

Shingle & Shake  
16A Parkhead Place, Albany, Auckland, New Zealand,  
T : 0800-SHINGLE | www.shingleandshake.co.nz

Sheet Title:

Staggered Valley Alternative  
3D Cutaway Details

Sheet Status:

For Design & Information  
S&S Technical Drawings 2020  
Technical Specification Subject to Change

Sheet Number:

1.7.1

Revision:

{v1.0}

Revision Date

Jan. 2020

Scale @ A4:

NTS



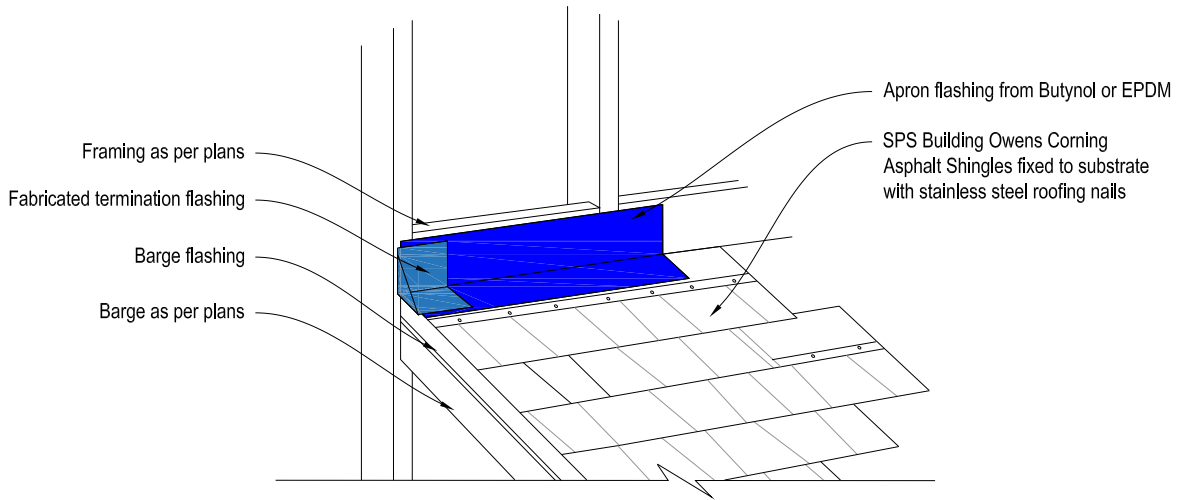

**STEP 1. APRON TERMINATION FLASHING**

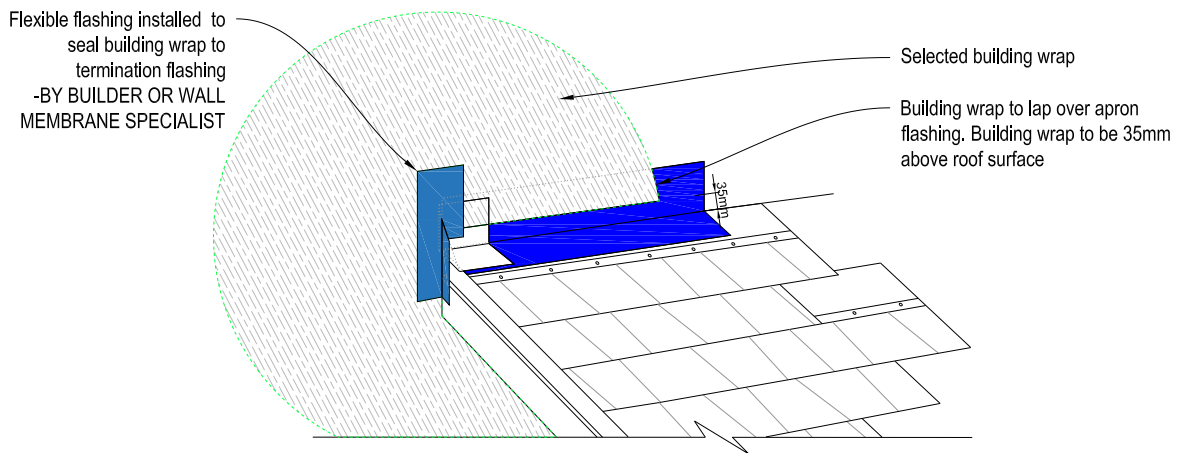

**STEP 2. APRON TERMINATION FLASHING**

# SHINGLE & SHAKE

SHINGLE ROOFING INSTALLERS

Shingle & Shake  
16A Parkhead Place, Albany, Auckland, New Zealand,  
T : 0800-SHINGLE | www.shingleandshake.co.nz

Sheet Title:

Apron Termination  
3D Cutaway Details

Sheet Status:

For Design & Information  
S&S Technical Drawings 2020  
Technical Specification Subject to Change

Sheet Number:

1.8

Revision:

{v1.0}

Revision Date

Jan. 2020

Scale @ A4:

NTS



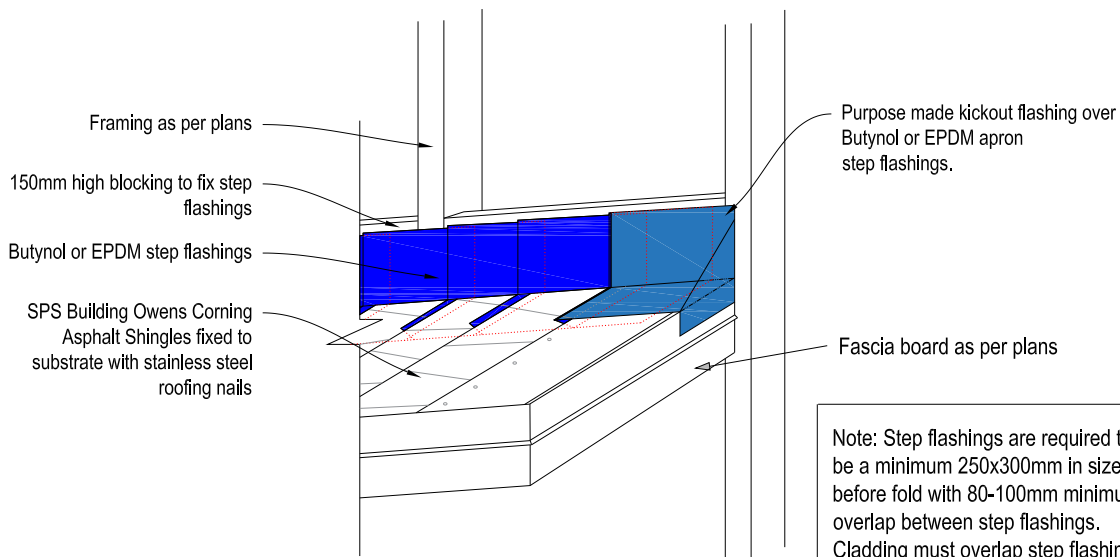

Note: Step flashings are required to be a minimum 250x300mm in size before fold with 80-100mm minimum overlap between step flashings. Cladding must overlap step flashings a minimum of 70mm.

**STEP 1. KICKOUT FLASHING**

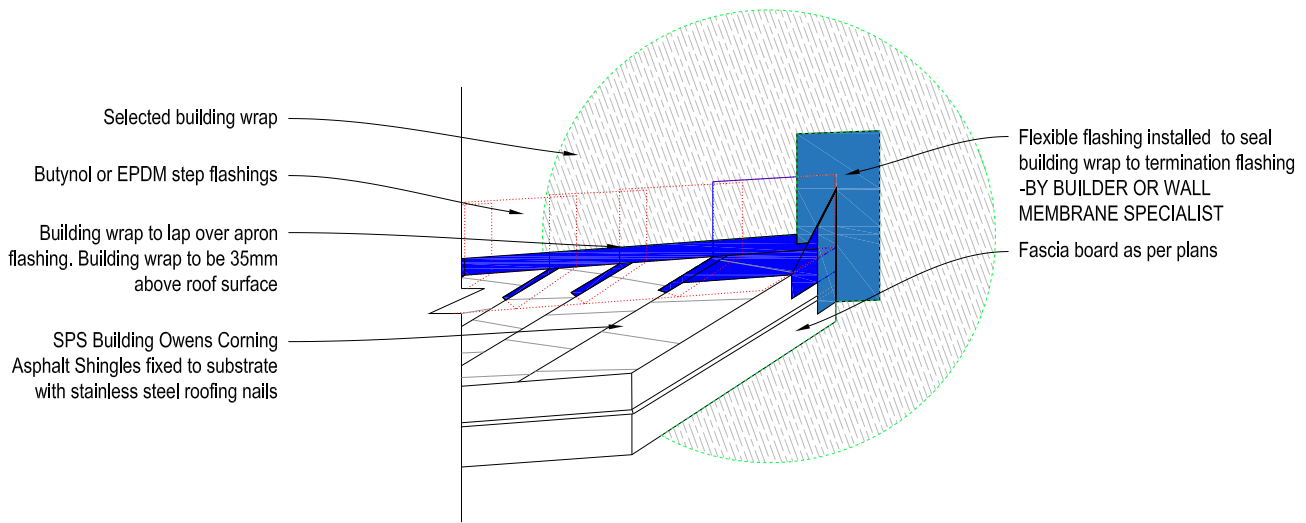

**STEP 2. KICKOUT FLASHING**

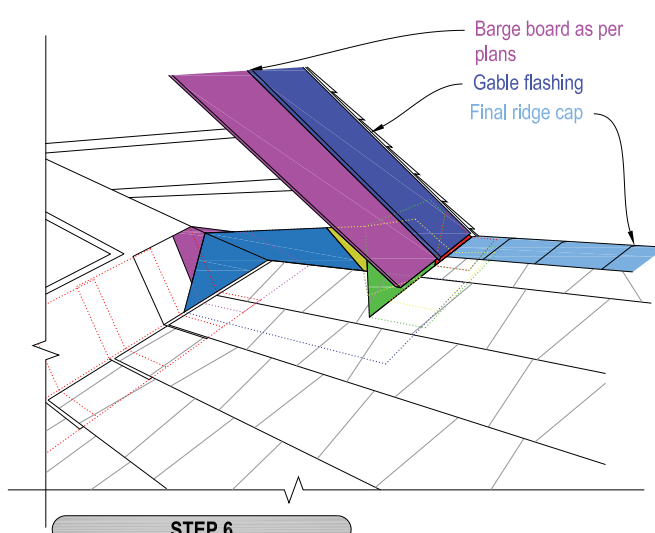
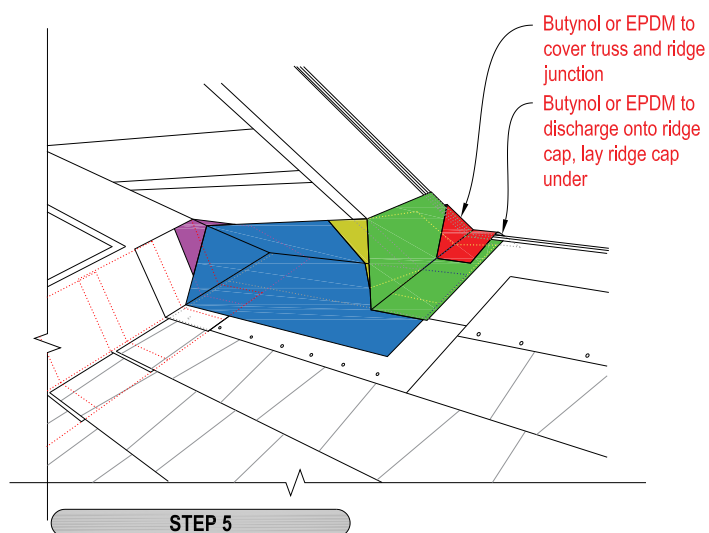
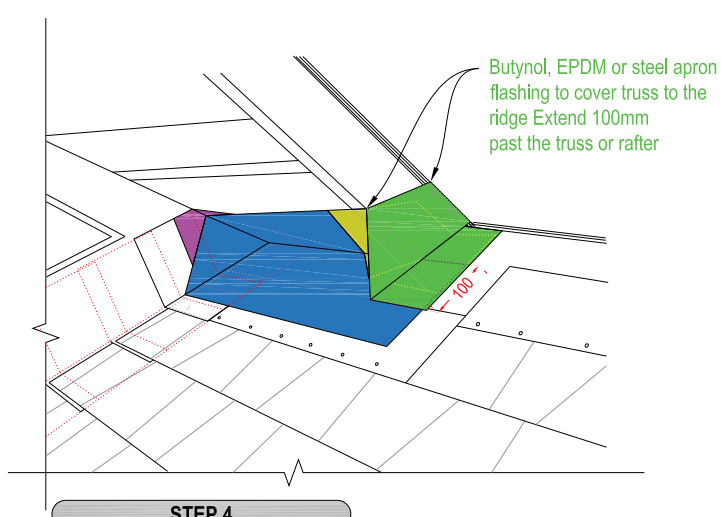
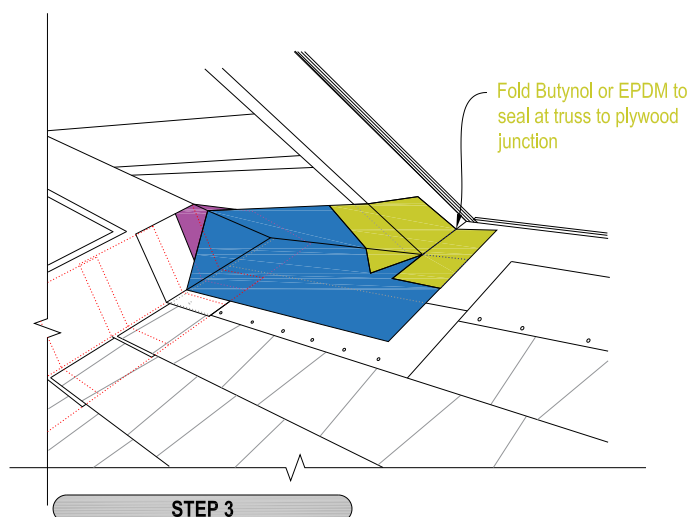
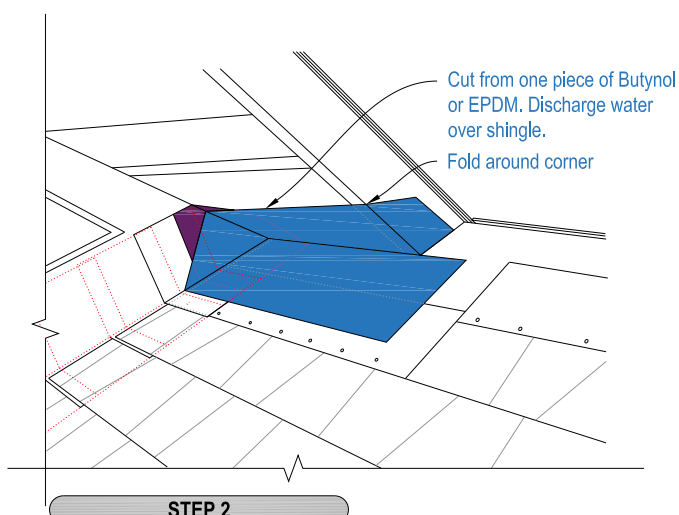
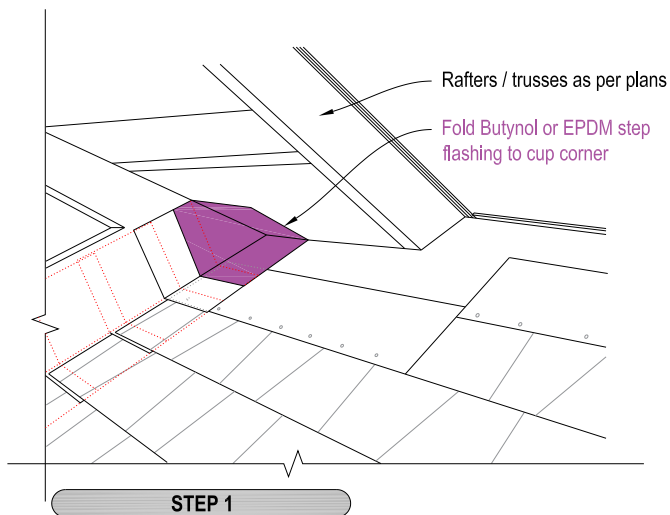

# SHINGLE & SHAKE

SHINGLE ROOFING INSTALLERS

Shingle & Shake  
16A Parkhead Place, Albany, Auckland, New Zealand,  
T: 0800-SHINGLE | www.shingleandshake.co.nz

Sheet Title:

Gable to Ridge  
3D Step-by-Step Details

Sheet Status:

For Design & Information  
S&S Technical Drawings 2020  
Technical Specification Subject to Change

Sheet Number:

2.1

Revision:

{v1.0}

Revision Date

Jan. 2020

Scale @ A4:

NTS



# Owens Corning - Asphalt Shingles - Typical Installation Detail Set

SPS Building Owens Corning Asphalt Shingle laid beneath plywood of overhanging eave.

Valley  $\epsilon$  formed between ply from each roof  
Standard stepped flashing up dormer wall  
Ply roofing of adjoining dormer roofs

MAIN ROOF

STEP 1

Lay single step flashing over junction of shingle and ply from dormer eave

STEP 2

Drip edge metal flashing of dormer roof plane edge to run over single step flashing

Starter course or Peel and Stick laid on top of metal drip edge flashing, to run through onto main roof to form valley seal.

STEP 3

STEP 4

Next layer of shingle as per standard laying to lap over step flashing and peel and stick.

SPS Building Owens Corning shingles from larger roof area to overlap shingles from smaller roof

Lay shingles across Valley from smaller roof to larger

First layer of shingle to dormer roof as per standard laying. After this step has been completed revert to standard valley system

STEP 5

STEP 6

## SHINGLE & SHAKE

SHINGLE ROOFING INSTALLERS

Shingle & Shake

16A Parkhead Place, Albany, Auckland, New Zealand,  
T: 0800-SHINGLE | www.shingleandshake.co.nz



Sheet Title:

Dormer to Valley  
3D Step-by-Step Details

Sheet Status:

For Design & Information  
S&S Technical Drawings 2020  
Technical Specification Subject to Change

Sheet Number:

2.2

Revision:

{v1.0}

Revision Date

Jan. 2020

Scale @ A4:

NTS

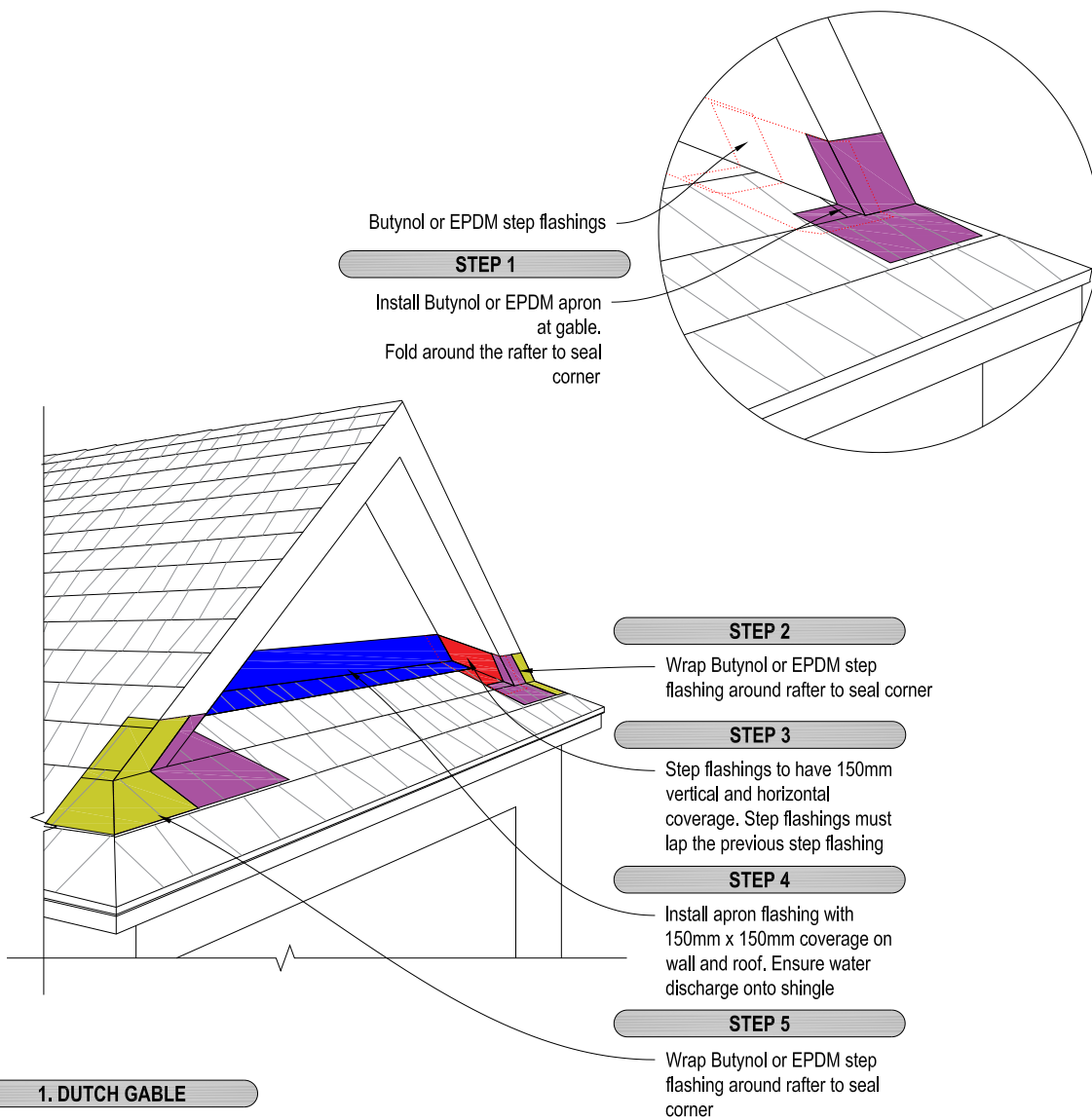

# SHINGLE & SHAKE

SHINGLE ROOFING INSTALLERS

Shingle & Shake  
16A Parkhead Place, Albany, Auckland, New Zealand,  
T: 0800-SHINGLE | www.shingleandshake.co.nz

Sheet Title:

Dutch Gable  
3D Step-by-Step Detail

Sheet Status:

For Design & Information  
S&S Technical Drawings 2020  
Technical Specification Subject to Change

Sheet Number:

2.3

Revision:

{v1.0}

Revision Date

Jan. 2020

Scale @ A4:

NTS



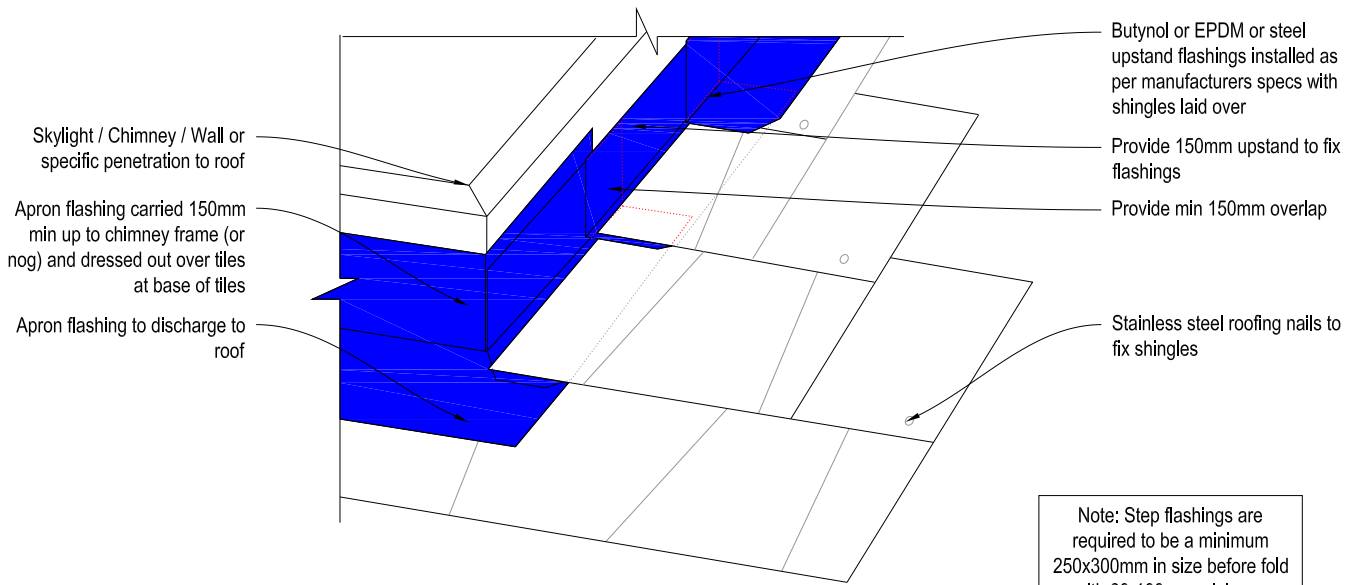

Note: Step flashings are required to be a minimum 250x300mm in size before fold with 80-100mm minimum overlap between step flashings. Cladding must overlap step flashings a minimum of 70mm.

**1. UPSTAND PENETRATION**

Note: Step flashings are required to be a minimum 250x300mm in size before fold with 80-100mm minimum overlap between step flashings. Cladding must overlap step flashings a minimum of 70mm.

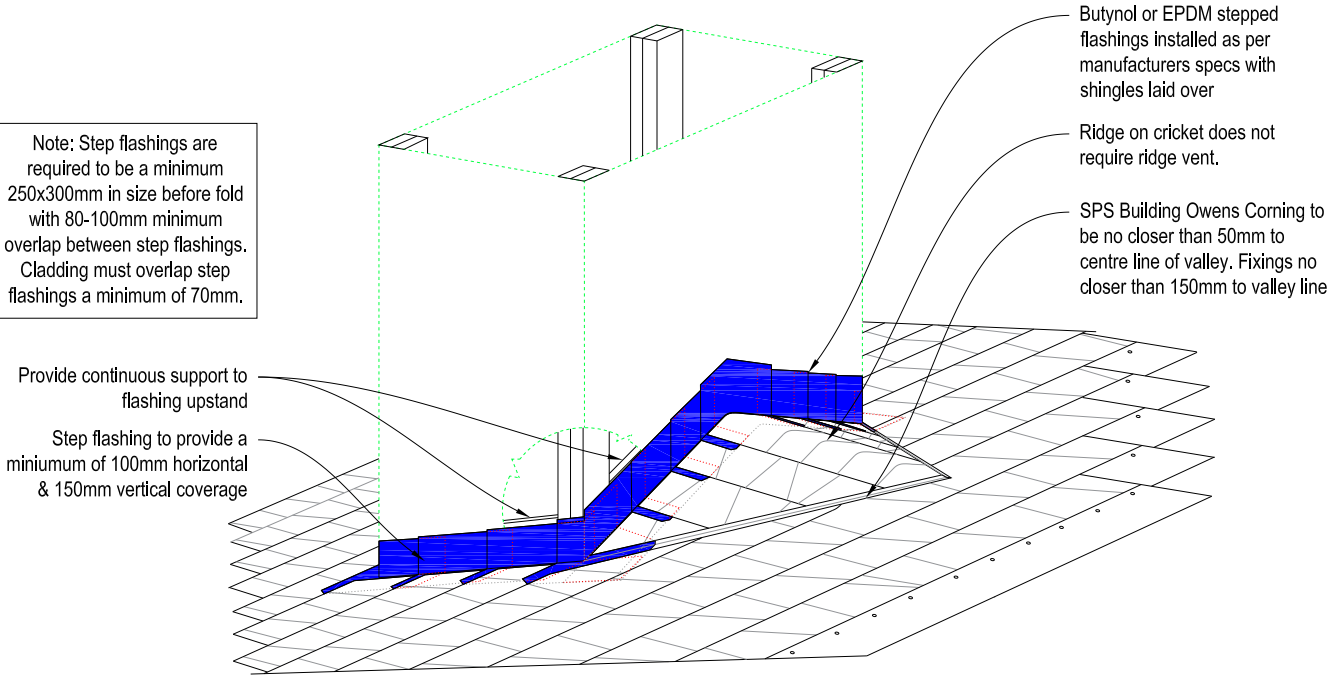

**2. CHIMNEY CRICKET**

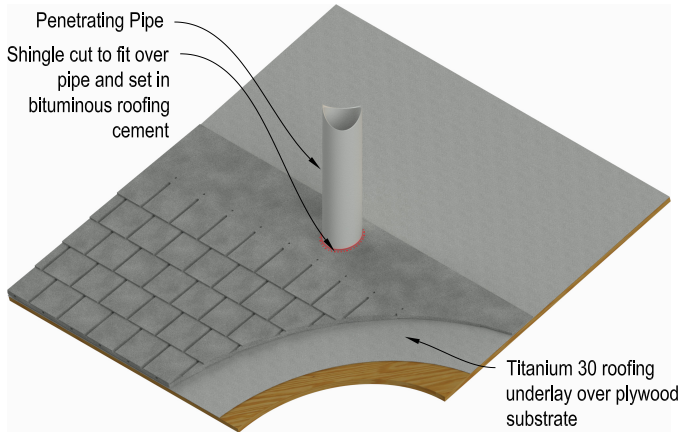

STEP 1

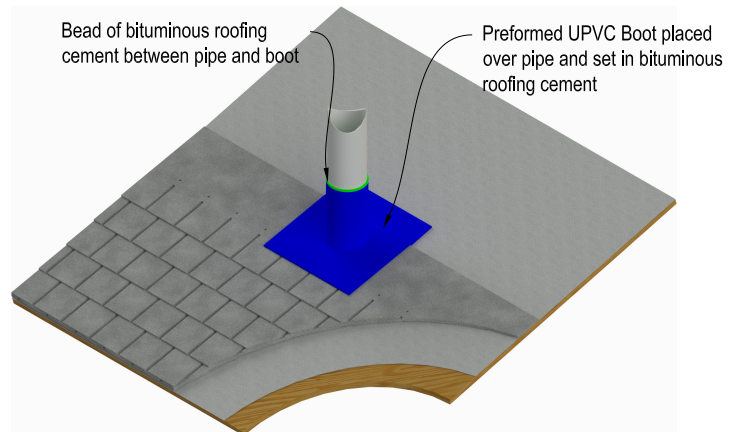

STEP 2

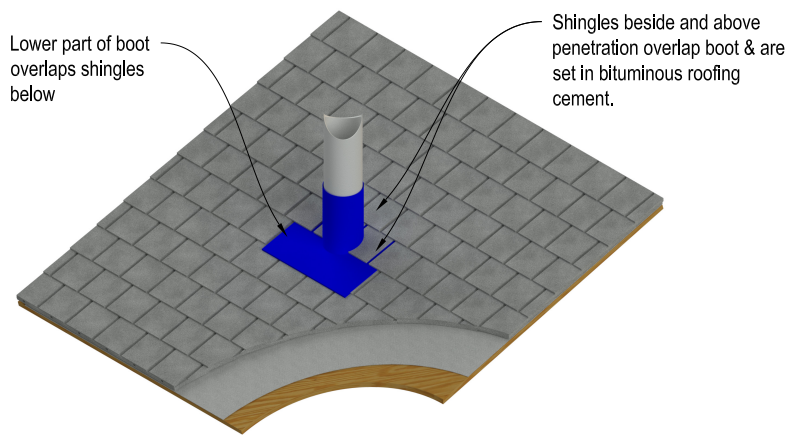

STEP 3

1. PIPE PENETRATION

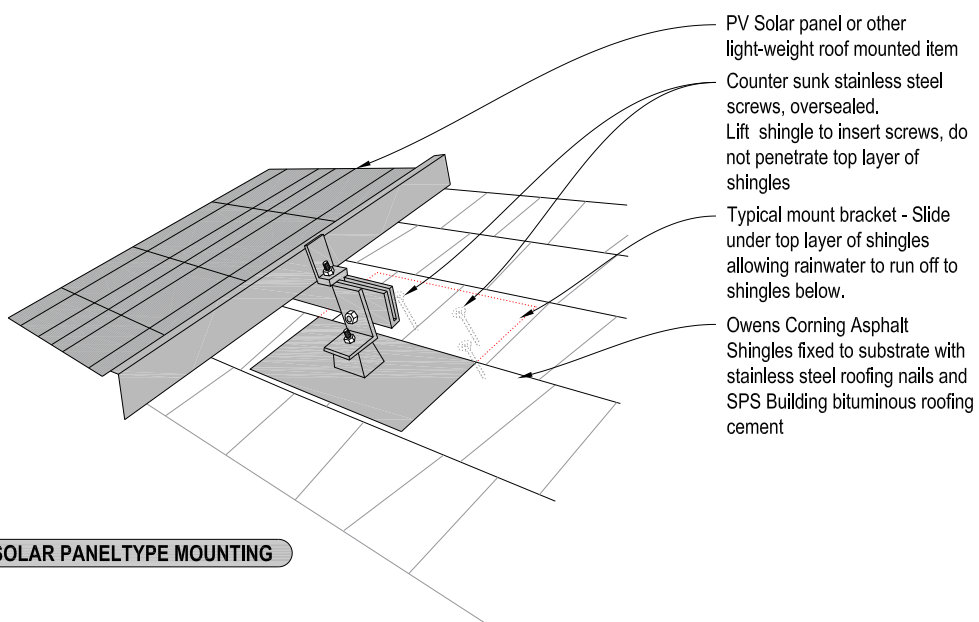

2. PV SOLAR PANELTYPE MOUNTING

**SHINGLE & SHAKE**

SHINGLE ROOFING INSTALLERS

Shingle & Shake  
16A Parkhead Place, Albany, Auckland, New Zealand,  
T: 0800-SHINGLE | www.shingleandshake.co.nz

Sheet Title:

Small Penetrations  
3D Cutaway Details

Sheet Status:

For Design & Information  
S&S Technical Drawings 2020  
Technical Specification Subject to Change

Sheet Number:

2.5

Revision:

{v1.0}

Revision Date

Jan. 2020

Scale @ A4:

NTS



Down pipe spreaders are critical for water discharge onto the shingle roof

MAX 25m<sup>2</sup> catchment per spreader shall be permitted to discharge onto lower roof area

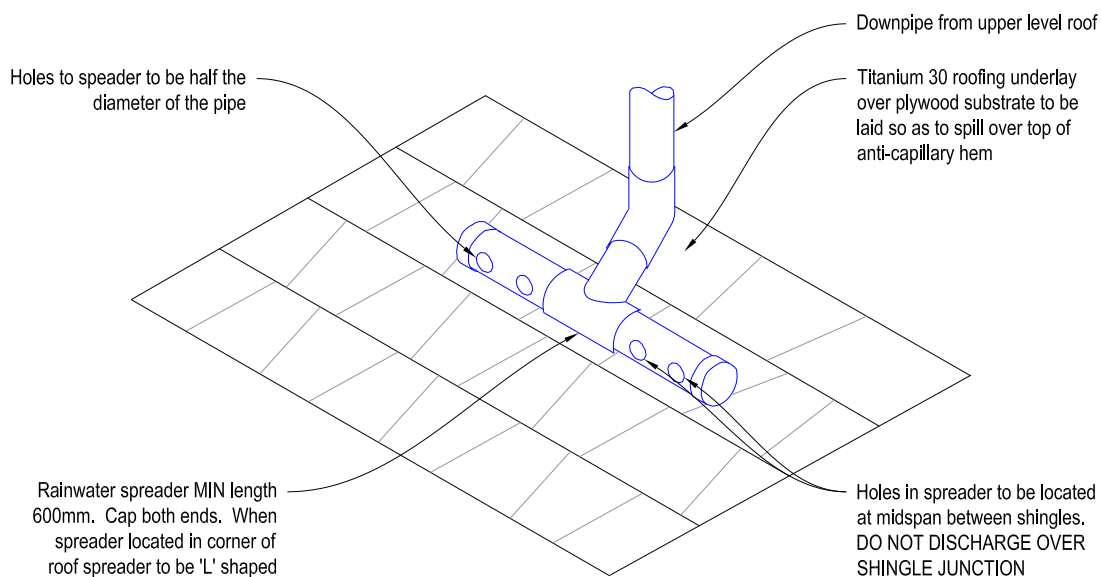

**1. DRAINAGE SPREADER**

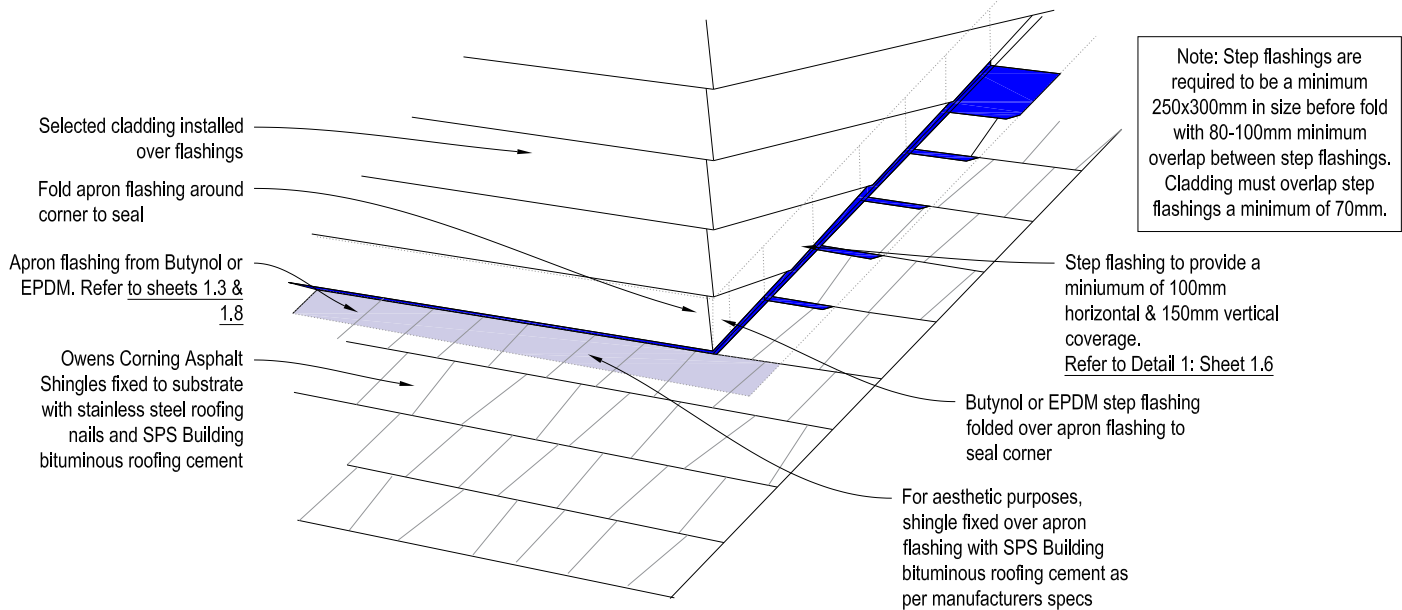

**1. WALL TO ROOF**

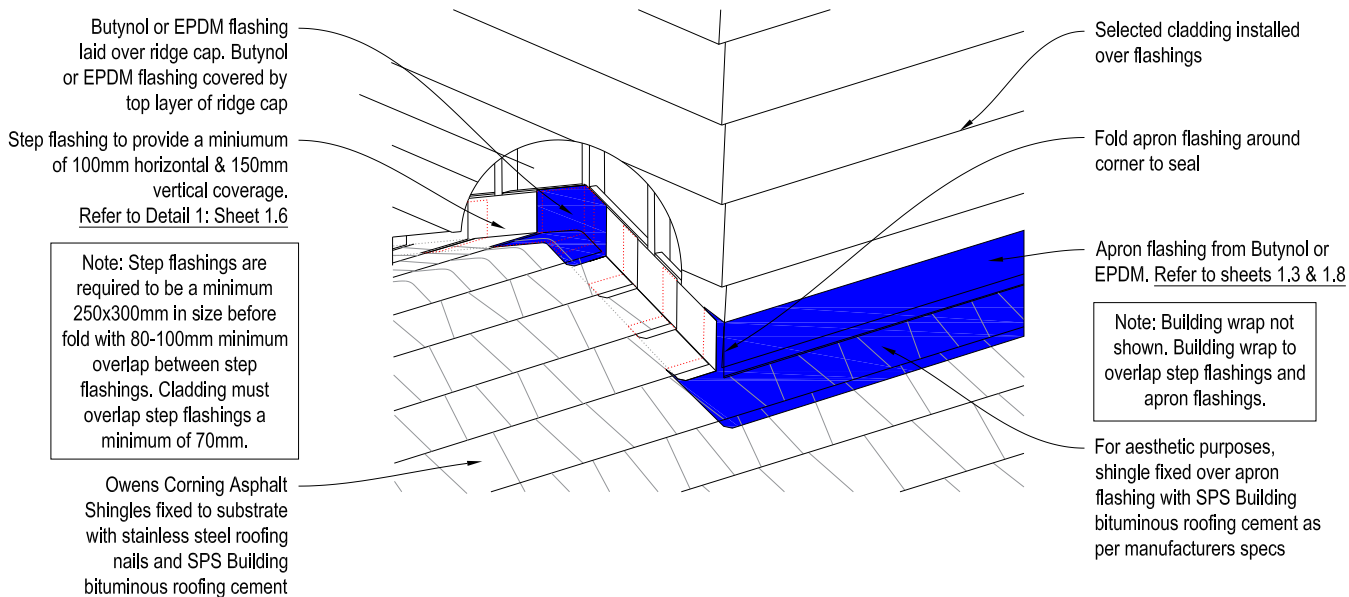

**2. WALL TO RIDGE**

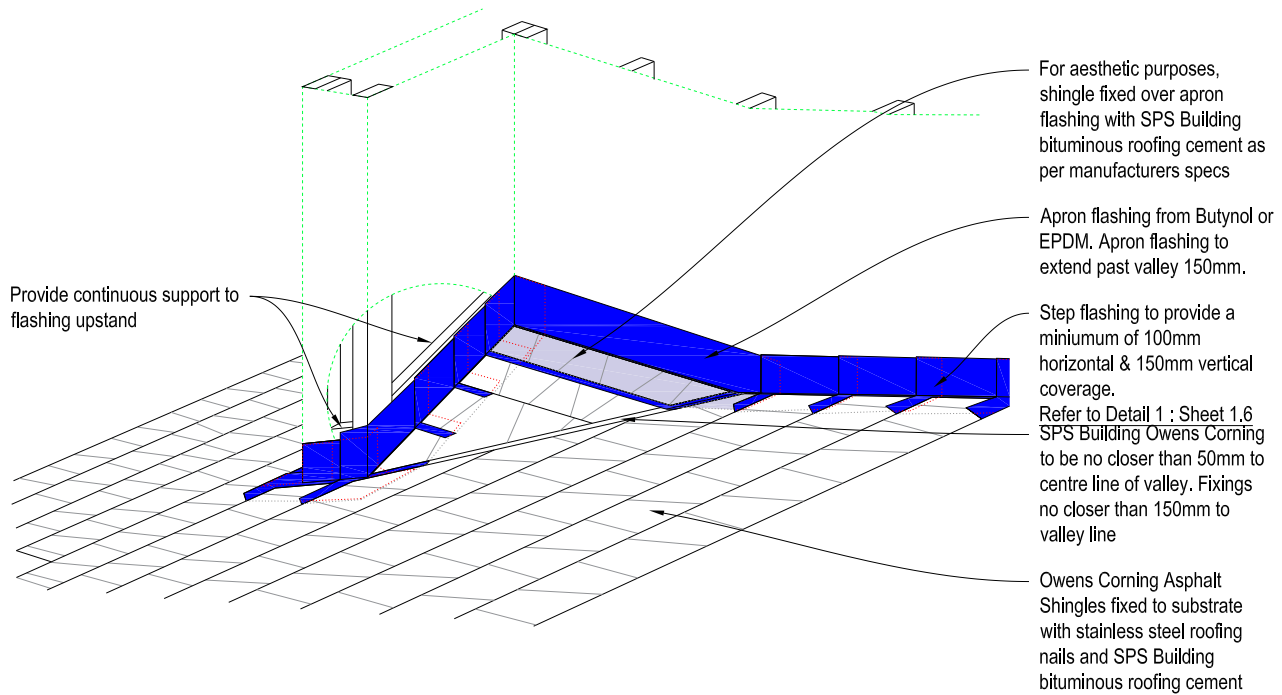

**1. INTERNAL VALLEY / CRICKET**

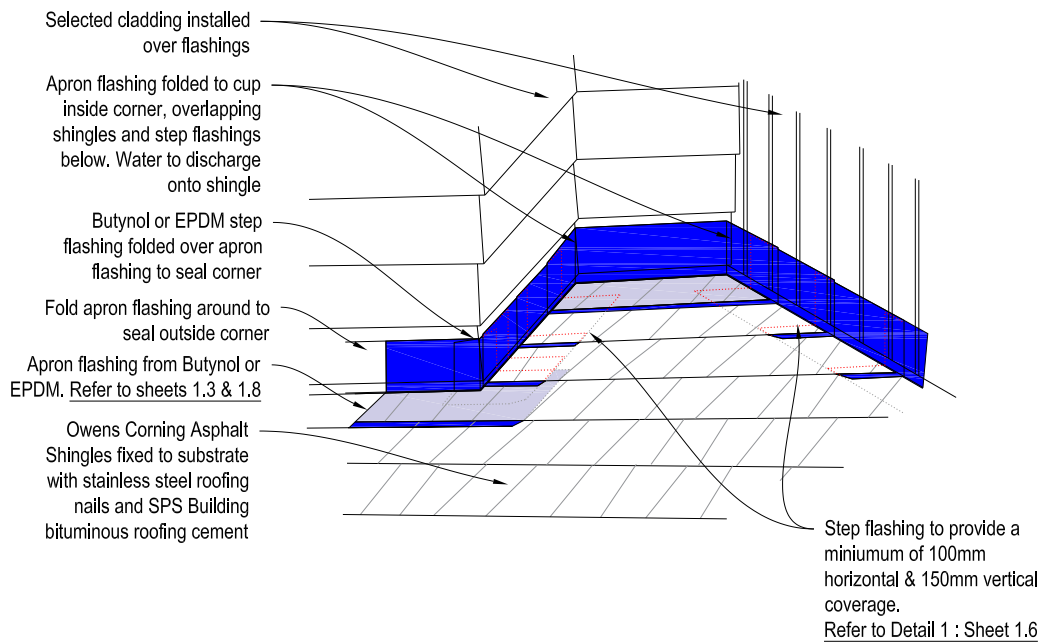

**2. WALL TO ROOF INTERNAL CORNER**

**SHINGLE & SHAKE**

SHINGLE ROOFING INSTALLERS

Shingle & Shake  
16A Parkhead Place, Albany, Auckland, New Zealand,  
T : 0800-SHINGLE | www.shingleandshake.co.nz

Sheet Title:

Internal Junctions to Wall BOC  
3D Cutaway Details

Sheet Status:

For Design & Information  
S&S Technical Drawings 2020  
Technical Specification Subject to Change

Sheet Number:

2.8

Revision:

{v1.0}

Revision Date

Jan. 2020

Scale @ A4:

NTS

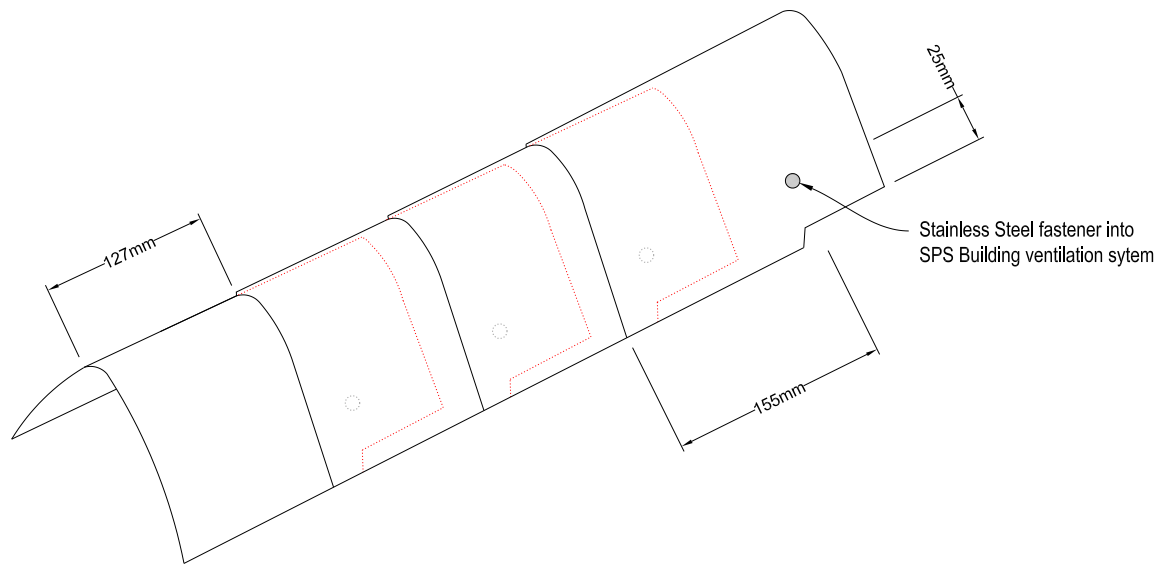
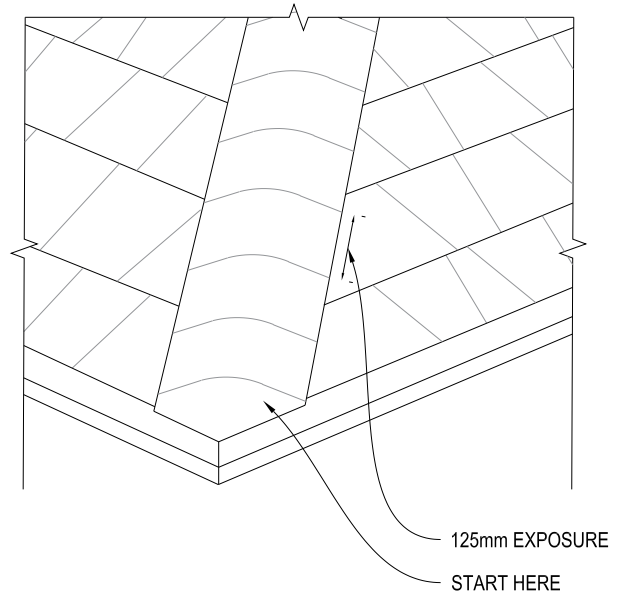
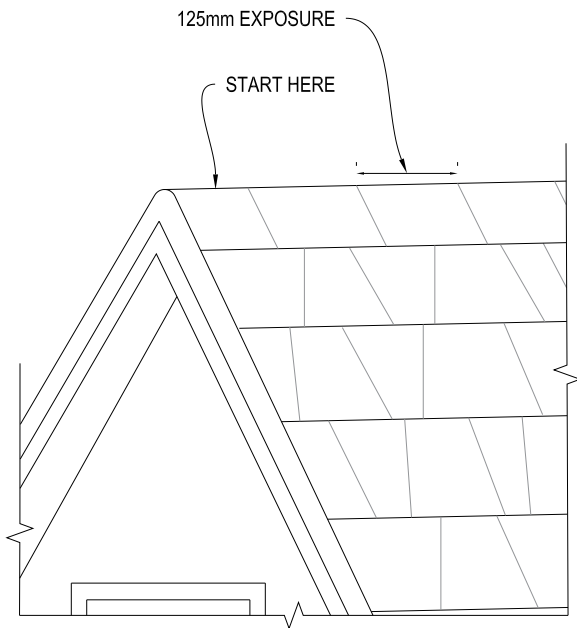

1. RIDGE & HIP CAPS

**SHINGLE & SHAKE**

SHINGLE ROOFING INSTALLERS

Shingle & Shake  
16A Parkhead Place, Albany, Auckland, New Zealand,  
T: 0800-SHINGLE | www.shingleandshake.co.nz

Sheet Title:

Ridge & Hip Caps  
3D Cutaway Details



Sheet Status:

For Design & Information  
S&S Technical Drawings 2020  
Technical Specification Subject to Change

Sheet Number:

2.9

Revision:

{v1.0}

Revision Date

Jan. 2020

Scale @ A4:

NTS

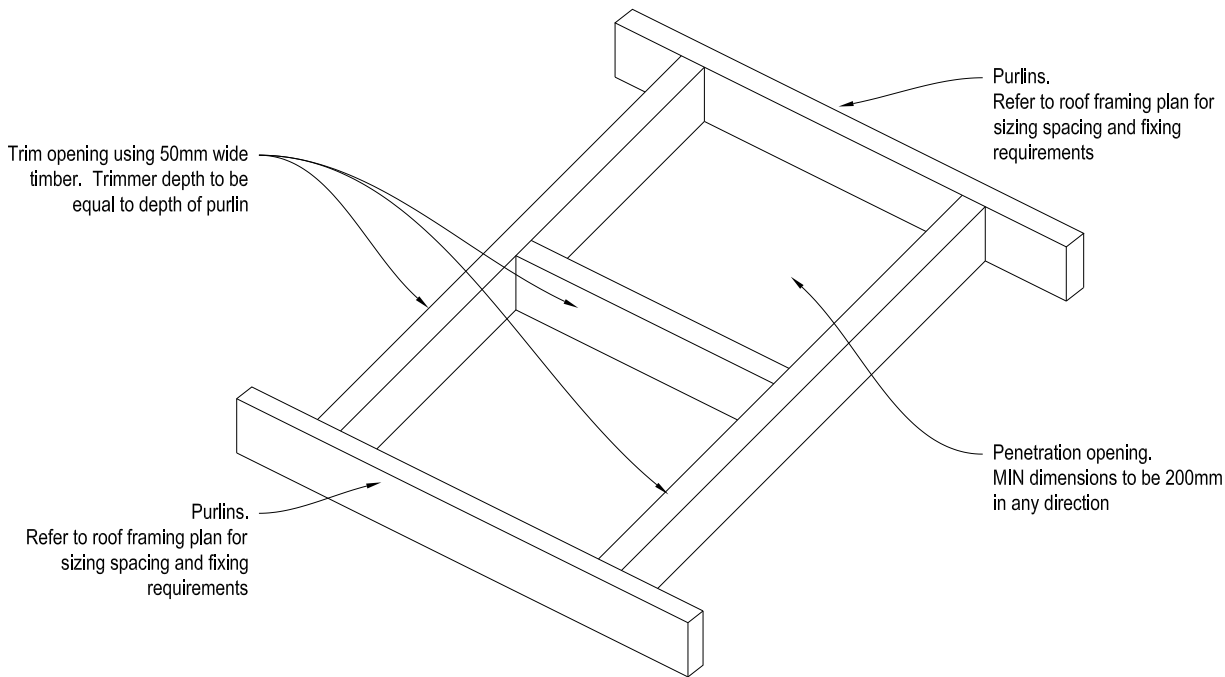

**1. APRON FLASHING DETAIL**

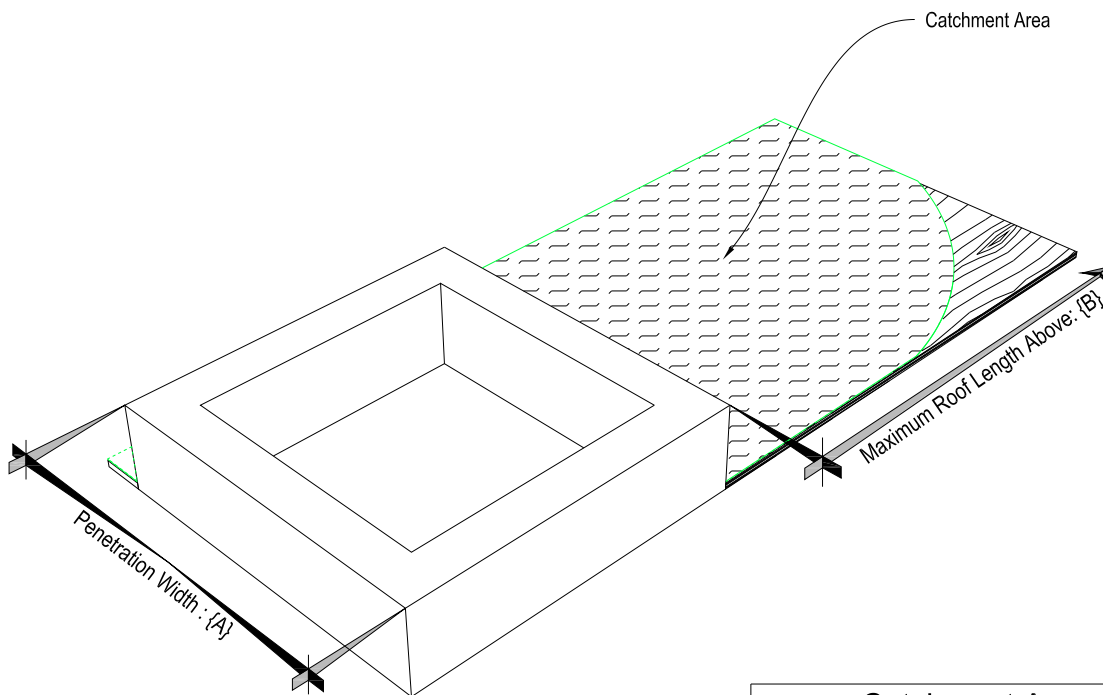

**2. VENTED APRON FLASHING DETAIL**

{A} Penetration Width	{B} Maximum Catchment Above
800 to 1200mm	4m
600 to 800mm	6m
400 to 600	8m
0 to 400	10m

## Roof Pitch of 9° - 17°



**HIGH PROFILE  
ROOF VENT**

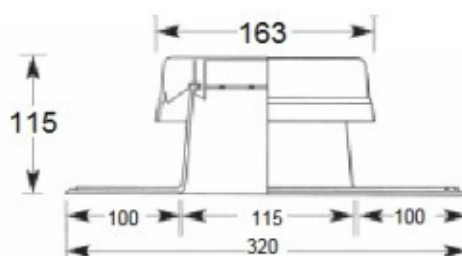
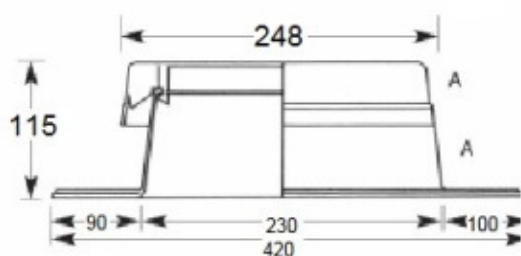
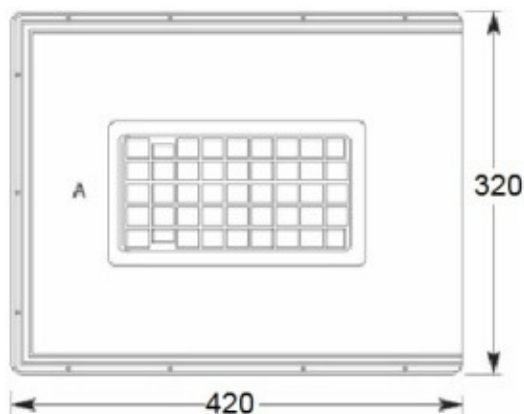

## Roof Pitch of Over 17°



**LOW PROFILE ROOF VENT**

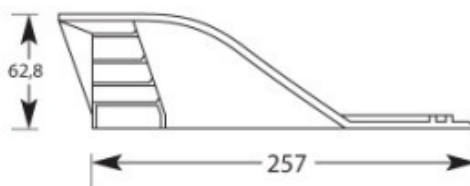
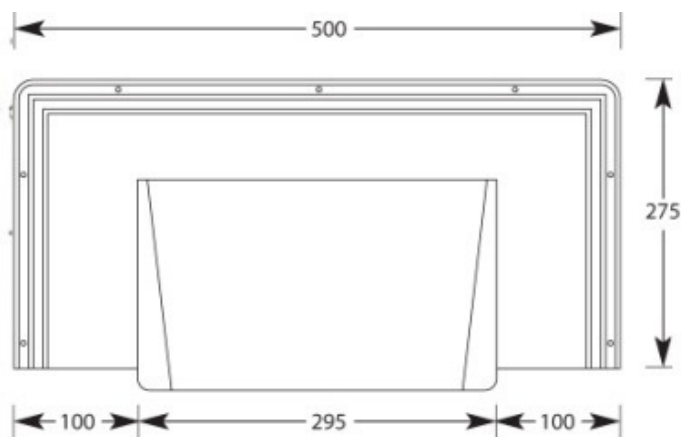

**Low profile and High profile vents:**

Vents must be used in areas where there are no ridges to vent the roof space.  
A hole is required to be cut into the plywood and the vents are to be fitted into the shingle rows to create a weather tight finish around them.

- High profile vents must be used where roof pitch is 17° or lower, this accessory provides 0.025m<sup>2</sup> Net Free Vent Area.
- Low profile vents must be used where roof pitch is over 17°, this accessory provides 0.018m<sup>2</sup> of Net Free Vent Area.

**SHINGLE & SHAKE**

SHINGLE ROOFING INSTALLERS

Shingle & Shake  
16A Parkhead Place, Albany, Auckland, New Zealand,  
T : 0800-SHINGLE | www.shingleandshake.co.nz

Sheet Title:

Roof Vents  
Sectional Details

Sheet Status:

For Design & Information  
S&S Technical Drawings 2020  
Technical Specification Subject to Change

Sheet Number:

3.2

Revision:

{v1.0}

Revision Date

Jan. 2020

Scale @ A4:

NTS



**∴ NOTE∴**  
 CUT APPROPRIATE SIZE  
 OPENING IN UNDERLAY  
 AND SUBSTRATE FOR  
 VENT.

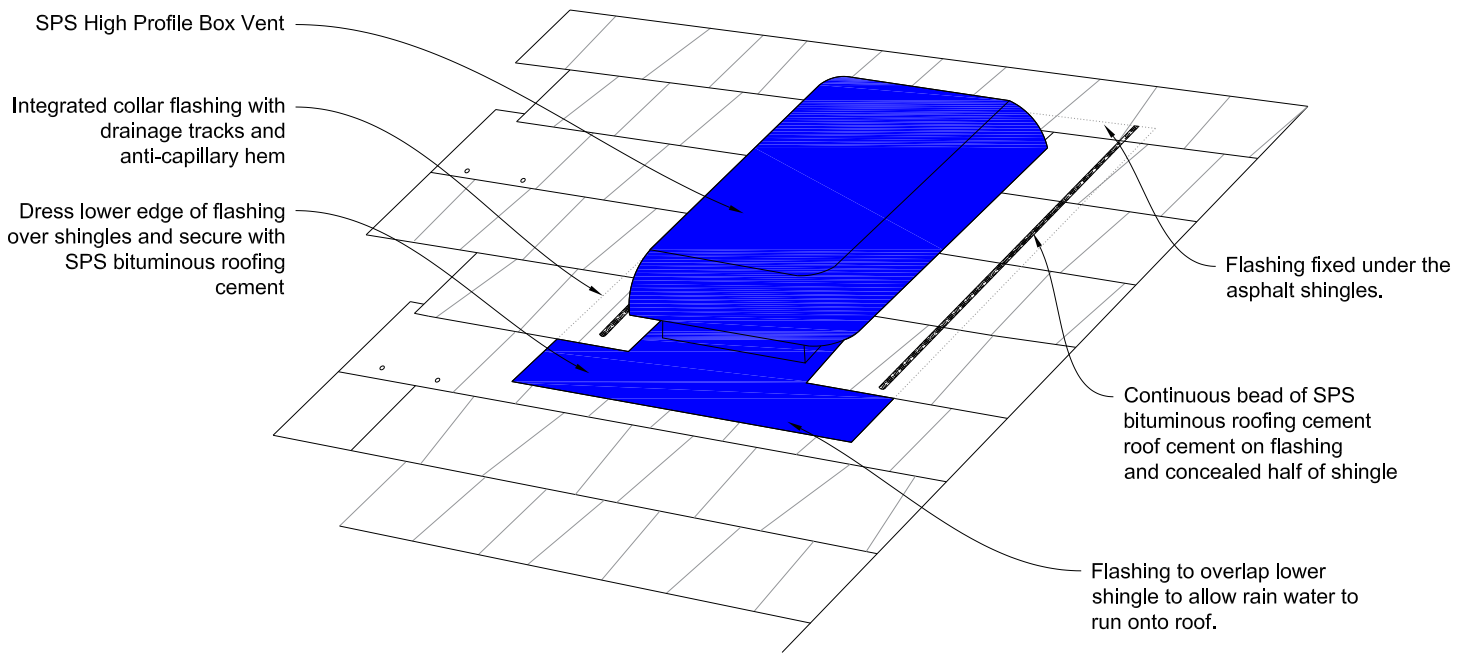

**1. Standard Box Vent**

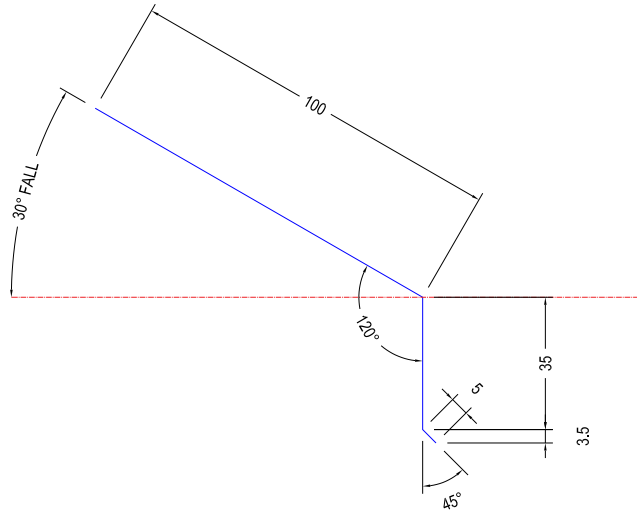

**0.55 BMT**  
**Coloursteel,**  
**Copper,**  
**or**  
**Stainless Steel**

**1. Standard Eave Flashing**

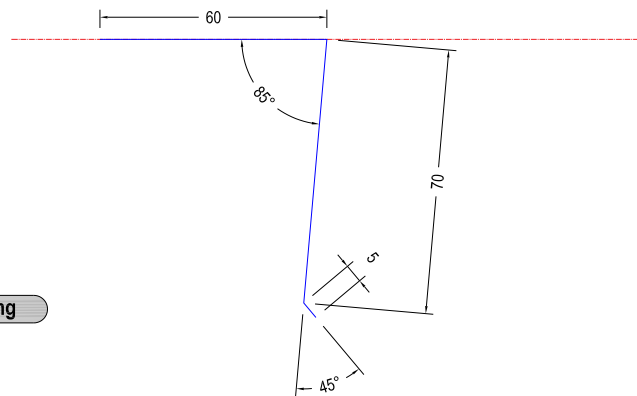

**0.55 BMT**  
**Coloursteel,**  
**Copper,**  
**or**  
**Stainless Steel**

**2. Standard Barge Flashing**